

T 20S R 15E M W

|   |   |    |   |   |   |    |   |   |    |    |    |    |    |    |    |    |    |    |    |    |    |    |    |    |
|---|---|----|---|---|---|----|---|---|----|----|----|----|----|----|----|----|----|----|----|----|----|----|----|----|
|   | 2 | 3  | 4 | 5 | 6 | 7  | 8 | 9 | 10 | 11 | 12 | 13 | 14 | 15 | 16 | 17 | 18 | 19 | 20 | 21 | 22 | 23 | 24 | 25 |
| A |   |    |   |   |   |    |   |   |    |    |    |    |    |    |    |    |    |    |    |    |    |    |    |    |
| B | + | +  | + |   | + |    |   |   | +  |    |    |    |    |    |    |    |    |    |    |    |    | +  | +  |    |
| C | + | 6  | + |   | + | 5  | + |   | +  | 4  | +  |    | +  | 3  | +  |    | +  | 2  | +  |    | +  | 1  | +  |    |
| D | + |    | + |   | + |    |   |   | +  |    |    |    |    |    |    |    |    |    |    |    |    | +  | +  |    |
| E |   |    |   |   |   |    |   |   |    |    |    |    |    |    |    |    |    |    |    |    |    |    |    |    |
| F | + |    | + |   | + |    |   |   | +  |    |    |    |    | +  |    |    | +  |    | +  |    | +  |    | +  |    |
| G | + | 7  | + |   | + | 8  | + |   | +  | 9  | +  |    | +  | 10 | +  |    | +  | 11 | +  |    | +  | 12 | +  |    |
| H | + |    | + |   | + |    |   |   | +  |    |    |    |    | +  |    |    | +  |    | +  |    | +  |    | +  |    |
| J |   |    |   |   |   |    |   |   |    |    |    |    |    |    |    |    |    |    |    |    |    |    |    |    |
| K |   |    |   |   |   |    |   |   |    |    |    |    |    |    |    |    |    |    |    |    |    |    |    |    |
| L | + | 18 | + |   | + | 17 | + |   | +  | 16 | +  |    | +  | 15 | +  |    | +  | 14 | +  |    | +  | 13 | +  |    |
| M | + |    | + |   | + |    |   |   | +  |    |    |    |    | +  |    |    | +  |    | +  |    | +  |    | +  |    |
| N | + | +  | + | + | + | +  | + | + | +  | +  | +  | +  | +  | +  | +  | +  | +  | +  | +  | +  | +  | +  | +  | +  |
| O | + |    | + |   | + |    |   |   | +  |    |    |    |    | +  |    |    | +  |    | +  |    | +  |    | +  |    |
| P | + | 19 | + |   | + | 20 | + |   | +  | 21 | +  |    | +  | 22 | +  |    | +  | 23 | +  |    | +  | 24 | +  |    |
| Q | + |    | + |   | + |    |   |   | +  |    |    |    |    | +  |    |    | +  |    | +  |    | +  |    | +  |    |
| R |   |    |   |   |   |    |   |   |    |    |    |    |    |    |    |    |    |    |    |    |    |    |    |    |
| S | + |    | + |   | + |    |   |   | +  |    |    |    |    | +  |    |    | +  |    | +  |    | +  |    | +  |    |
| T | + | 30 | + |   | + | 29 | + |   | +  | 28 | +  |    | +  | 27 | +  |    | +  | 26 | +  |    | +  | 25 | +  |    |
| U | + |    | + |   | + |    |   |   | +  |    |    |    |    | +  |    |    | +  |    | +  |    | +  |    | +  |    |
| V |   |    |   |   |   |    |   |   |    |    |    |    |    |    |    |    |    |    |    |    |    |    |    |    |
| W | + |    | + |   | + |    |   |   | +  |    |    |    |    | +  |    |    | +  |    | +  |    | +  |    | +  |    |
| X | + | 31 | + |   | + | 32 | + |   | +  | 33 | +  |    | +  | 34 | +  |    | +  | 35 | +  |    | +  | 36 | +  |    |
| Y | + |    | + |   | + |    |   |   | +  |    |    |    |    | +  |    |    | +  |    | +  |    | +  |    | +  |    |
| Z |   |    |   |   |   |    |   |   |    |    |    |    |    |    |    |    |    |    |    |    |    |    |    |    |

LEGEND

○ = Corner having information on form 7100-52 in this file.

*Legend conforms to Reporting Form 4/79 MB*

FILING INSTRUCTION

File 7100-52 card record by letter and number coordinates behind the file guide for the township in which it falls.

File the 7100-52 card record by letter and then by number i.e., all A cards first, then B cards etc.

The first card behind the file guide (if data have been obtained and recorded) will be card A-1 for N.W. Township Corner, then card A-2 for 1/16 corner then card A-3 for 1/4 corner etc.

CORNER RECORD FILE GUIDE (Rectangular Surveys)

*R15  
R16*

7100-55 (2/67)

Index  
File No. 0157

**CORNER RECORD (SEARCH)**

(Ref. FSM 7151.4)

Tract or  
Survey No. \_\_\_\_\_ Cor.  
No. G-1

T 20 S R. 15 E. R.D. Ft. Rock County Deschutes

Merid. Willamette N.F. Deschutes State Oregon

**CORNER DIAGRAM**

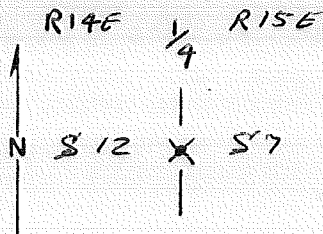

**DESCRIBE CORNER MONUMENT FOUND**

Stone ~~to~~ of call size, with possible chisel marks, No other stones in the area.

**DESCRIBE BEARING TREES OR OTHER OFFICIAL ACCESSORIES FOUND**

**PHOTO IDENTIFICATION DATA**

Photo No. \_\_\_\_\_

Filed At. \_\_\_\_\_

Object Ident. \_\_\_\_\_

Ident. By \_\_\_\_\_

*Signature*

**PLANE COORDINATE POSITION DATA**

State \_\_\_\_\_ Zone \_\_\_\_\_

X \_\_\_\_\_

Y \_\_\_\_\_

Estab. By \_\_\_\_\_

*Agency*

**DESCRIBE CORNER LOCATION RELATIVE TO NEAR-BY FEATURES, ALSO HOW TO REACH CORNER**

stone is 1 1/2 miles North of <sup>13<sup>18</sup></sup>/<sub>24<sup>19</sup></sub>, laying on its side, on E. edge of Road, approx. 20 ft. west of fence line.

Signature *w. Hum*

*R. Vasquez, L. Day*

Title

Division

Headquarters

Date

FS-7100-52 (3/68)

*10-31-89*

CORNER RECORD (PERPETUATION)

MONUMENT: DESCRIBE NEW MONUMENT SET, OR WORK DONE TO PRESERVE EXISTING MONUMENT

9

ACCESSORIES : DESCRIBE NEW BT<sup>1</sup>/<sub>2</sub> WITNESS OBJECTS ETC. ESTABLISHED, OR WORK DONE TO PRESERVE EXISTING EVIDENCE

10

Work Done By \_\_\_\_\_ Title \_\_\_\_\_ Date \_\_\_\_\_ State Registration No. or Agency \_\_\_\_\_

Certified Cor. Record Prepared? Yes No Filed At: \_\_\_\_\_ Date \_\_\_\_\_

11

GLO Survey of 1800 by F.W. Campbell REMARKS

Set Basalt stone, 18X9X6 for ~~corner of Secs. 6~~  
1/4 Sec. Corner with pits as per instructions

12

Index File No. T. R. M. Tract or Surv. No. Cor. \_\_\_\_\_

13

USDA-FOREST SERVICE

Index  
File No. 0163

CORNER RECORD (SEARCH)

(Ref. FSM 7151.4)

Tract or Survey No. \_\_\_\_\_ Cor. No. N-1

T 20 S R. 15 E R.D. Ft. Rock County Deschutes

Merid. Willamette N.F. Deschutes State Oregon

CORNER DIAGRAM

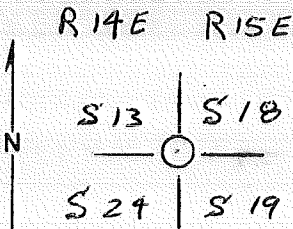

DESCRIBE CORNER MONUMENT FOUND

Found stone of call size laying on the ground at fence corner

DESCRIBE BEARING TREES OR OTHER OFFICIAL ACCESSORIES FOUND

PHOTO IDENTIFICATION DATA

Photo No. \_\_\_\_\_  
Filed At. \_\_\_\_\_  
Object Ident. \_\_\_\_\_  
Ident. By \_\_\_\_\_

*Signature*

PLANE COORDINATE POSITION DATA

State \_\_\_\_\_ Zone \_\_\_\_\_  
X \_\_\_\_\_  
Y \_\_\_\_\_  
Estab. By \_\_\_\_\_

*Agency*

Signature W Ham  
R Vasquez, L. Day

Title \_\_\_\_\_

Division \_\_\_\_\_

Headquarters \_\_\_\_\_

Date 10-31-89

FS-7100-52 (3/68)

CORNER RECORD (PERPETUATION)

MONUMENT: DESCRIBE NEW MONUMENT SET, OR WORK DONE TO PRESERVE EXISTING MONUMENT

9

ACCESSORIES : DESCRIBE NEW B<sup>T</sup>'s WITNESS OBJECTS ETC. ESTABLISHED, OR WORK DONE TO PRESERVE EXISTING EVIDENCE

10

Work Done By \_\_\_\_\_ Title \_\_\_\_\_ Date \_\_\_\_\_ State Registration No. or Agency \_\_\_\_\_

Certified Cor. Record Prepared? Yes No Filed At: \_\_\_\_\_ Date \_\_\_\_\_

11

610 Survey of 1880 by F. W. Campbell REMARKS

Set Basalt Stone 24 X 12 X 5 with pits as per instructions,

12

Index File No. T. R. M. Tract or Surv. No. Cor.

13

Index  
File No. 0363

**CORNER RECORD (SEARCH)**

(Ref. FSM 7151.4)

Tract or Survey No. \_\_\_\_\_ Cor. No. N-3

T 20 S R. 15 E. R.D. Ft. Rock County Deschutes

Merid. Willamette N.F. Deschutes State Oregon

CORNER DIAGRAM

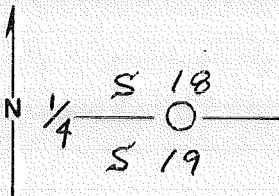

DESCRIBE CORNER MONUMENT FOUND

*None found, area has been disturbed by fence building activity*

DESCRIBE BEARING TREES OR OTHER OFFICIAL ACCESSORIES FOUND

PHOTO IDENTIFICATION DATA

Photo No. \_\_\_\_\_  
Filed At. \_\_\_\_\_  
Object Ident. \_\_\_\_\_  
Ident. By \_\_\_\_\_

*Signature*

PLANE COORDINATE POSITION DATA

State \_\_\_\_\_ Zone \_\_\_\_\_  
X \_\_\_\_\_  
Y \_\_\_\_\_  
Estab. By \_\_\_\_\_

*Agency*

Signature *W. Ham*

Title \_\_\_\_\_

Division \_\_\_\_\_

Headquarters \_\_\_\_\_

Date *10-31-89*

FS-7100-52 (3/68)

CORNER RECORD (PERPETUATION)

MONUMENT: DESCRIBE NEW MONUMENT SET, OR WORK DONE TO PRESERVE EXISTING MONUMENT

9

ACCESSORIES : DESCRIBE NEW BT'S WITNESS OBJECTS ETC. ESTABLISHED, OR WORK DONE TO PRESERVE EXISTING EVIDENCE

10

Work Done By \_\_\_\_\_ Title \_\_\_\_\_ Date \_\_\_\_\_ State Registration No. or Agency \_\_\_\_\_

Certified Cor. Record Prepared? Yes No Filed At: \_\_\_\_\_ Date \_\_\_\_\_ 11

GLO Survey of 1880 by F.W. Campbell REMARKS

Set stone 15 X 9 X 7 for 1/4 sec. corner with pits as per instructions

12

Index File No. T. R. M. Tract or Surv. No. Cor. 13

USDA-FOREST SERVICE

Index  
File No. 0563 (N-5)

CORNER RECORD (SEARCH)

(Ref. FSM 7151.4)

Tract or  
Survey No. \_\_\_\_\_

Cor.  
No. N-5

T 20 S R. 15 E R.D. Ft. Rock County Deschutes SW Cor Sec. 17

Merid. W. Yamette N.F. Deschutes State Oregon

CORNER DIAGRAM

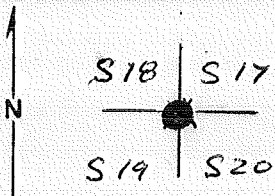

DESCRIBE CORNER MONUMENT FOUND

original stone 16x12x12, marked with 5 grooves on E. & 3 notches on S edges; in a mound of stone

DESCRIBE BEARING TREES OR OTHER OFFICIAL ACCESSORIES FOUND

PHOTO IDENTIFICATION DATA

Photo No. \_\_\_\_\_

Filed At. \_\_\_\_\_

Object Ident. \_\_\_\_\_

Ident. By \_\_\_\_\_

Signature

PLANE COORDINATE POSITION DATA

State \_\_\_\_\_ Zone \_\_\_\_\_

X \_\_\_\_\_

Y \_\_\_\_\_

Estab. By \_\_\_\_\_

Agency

DESCRIBE CORNER LOCATION RELATIVE TO NEAR-BY FEATURES, ALSO HOW TO REACH CORNER

Location poster on steel fence post in E/W fence line bears N. 72° E., 10.7 ft. Parcel line 4.5' No unmarked road, running N/S bears West approx. 800 ft.

Signature R. Vasquez

Title \_\_\_\_\_

Division \_\_\_\_\_

Headquarters \_\_\_\_\_

Date

FS-7100-52 (3/68)

10/30/89



**CORNER RECORD (PERPETUATION)**

MONUMENT: DESCRIBE NEW MONUMENT SET, OR WORK DONE TO PRESERVE EXISTING MONUMENT

Set ACAP 24" into ground. ~~Steel fence post~~ 6' East

7205  
S18 S17 R  
S19 S20 IS  
PLS 2396 E  
1993

ACCESSORIES : DESCRIBE NEW BT'S WITNESS OBJECTS ETC. ESTABLISHED, OR WORK DONE TO PRESERVE EXISTING EVIDENCE

A rebar rising 18" brs N55 1/2° E @ 23.3' w/AC MKD B.O. 1 S17  
PLS 2396 1993

A boulder 3' x 1' x 5" brs S52 1/4° E @ 32.6' MKD X B.O.

A rebar rising 4" brs S.55° W @ 14 1/2' with AC MKD B.O. 3 S19  
PLS 2396 1993

A Juniper, 3" dia. brs N17 1/2° W @ 209 3/4' MKD X BT  
Steel fence post 6' East

Work Done By Bill Ham Title PLS Date 5/93 State Registration No. 2396  
or Agency

Certified Cor. Record Prepared?  Yes  No Filed At: Deschutes Co. Date 5/18/93

660 Survey of 1880 by F.W. Campbell REMARKS

Set. stone 12 X 12 X 12 for corner to Secs. 17, 18, 19 & 20, in  
a mound of stone.

Index File No. T. R. M. Tract or Surv. No. Cor. 12  
13

0563

Cor. N-5

USDA-FOREST SERVICE

Index  
File No. 0763

CORNER RECORD (SEARCH)  
(Ref. FSM 7151.4)

Tract or  
Survey No. \_\_\_\_\_  
Cor. No. N-07

T 20 S. R. 15 E.  
Merid. W Mt

R.D. ~~SISTER~~ FT ROCK County Deschutes  
N.F. Deschutes State Oregon

3/4 Sec. 17

CORNER DIAGRAM

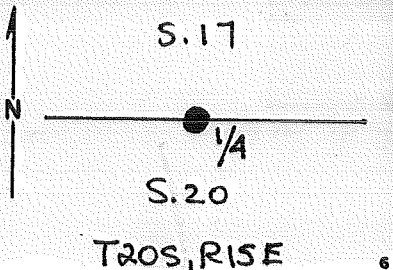

DESCRIBE CORNER MONUMENT FOUND

Original stone 18" X 14" X 4" marked 1/4 on North face, in a mound of stone.  
No evidence of pits.

DESCRIBE BEARING TREES OR OTHER OFFICIAL ACCESSORIES FOUND

PHOTO IDENTIFICATION DATA

Photo No. \_\_\_\_\_  
Filed At. \_\_\_\_\_  
Object Ident. \_\_\_\_\_  
Ident. By \_\_\_\_\_  
*Signature*

DESCRIBE CORNER LOCATION RELATIVE TO NEAR-BY FEATURES, ALSO HOW TO REACH CORNER

PLANE COORDINATE POSITION DATA

State \_\_\_\_\_ Zone \_\_\_\_\_  
X \_\_\_\_\_  
Y \_\_\_\_\_  
Estab. By \_\_\_\_\_  
*Agency*

|                       |            |           |              |              |                   |
|-----------------------|------------|-----------|--------------|--------------|-------------------|
| Signature             | Title      | Division  | Headquarters | Date         | FS-7100-52 (3/68) |
| <u>William B. Ham</u> | <u>PLS</u> | <u>CS</u> | <u>SO</u>    | <u>12/92</u> |                   |

## CORNER RECORD (PERPETUATION)

**MONUMENT: DESCRIBE NEW MONUMENT SET, OR WORK DONE TO PRESERVE EXISTING MONUMENT**

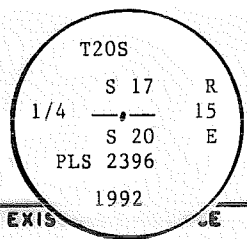

Set a 2 1/2" dia. X 30" long aluminum pipe surmounted by a 2 1/2" dia. aluminum cap, in a mound of stone. Penny at base of pipe. Orig. stone buried alongside. Steel fence post 6.2 ft. East.  
 Rebar, 5/8" X 30", in stone mound, N.34°45'E., 19.5ft., with aluminum cap marked BO 1 PLS 2396 1992  
 A Juniper, 8" dia., S.07°E., 382.7 ft., marked 1/4 S20 BT  
 A PK nail in a 3.5 ft.X 4.5 ft. X 2 ft. high boulder, S.46°15'W., 51.9 ft marked BO  
 A Juniper, 3" dia., N. 56°15'W., 140.1 ft., marked X BT  
 A brass washer marked PLS 2396 nailed between the B and T in the scribing.

10

Work Done By William B. Ham Title PLS Date 12/92 State Registration No. 2396  
 or Agency \_\_\_\_\_

Certified Cor. Record Prepared?  (Yes) No Filed At: Deschutes County Date 1/5/93

11

**REMARKS**

Survey of 1880 by Meldrum, Moore & Campbell.  
 Set stone 16X12X4 for 1/4 Sec. corner with pits as per instructions.

12

|                |    |    |    |                     |             |
|----------------|----|----|----|---------------------|-------------|
| Index File No. | T. | R. | M. | Tract or Surv. No.  | Cor.        |
| <u>0763</u>    |    |    |    |                     |             |
|                |    |    |    | GPO: 1986 O-439-095 | <u>N-07</u> |

13

USDA-FOREST SERVICE

Index  
File No. 0963 (N-9)

CORNER RECORD (SEARCH)  
(Ref. FSM 7151.4)

Tract or  
Survey No. \_\_\_\_\_  
Cor. No. N-9

T 20 S R. 15 E R.D. Ft. Rock County Deschutes

Merid. Willamette N.F. Deschutes State Oregon

CORNER DIAGRAM

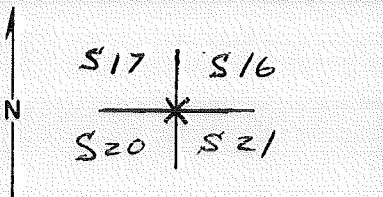

DESCRIBE CORNER MONUMENT FOUND

Original corner stone, 13 X 12 X 6 ins., set firmly in the ground, marked with 3 notches on south and 4 notches on East edges; in a mound of stone.

DESCRIBE BEARING TREES OR OTHER OFFICIAL ACCESSORIES FOUND

No pits found, ground has been heavily grazed.

PHOTO IDENTIFICATION DATA

Photo No. \_\_\_\_\_  
Filed At. \_\_\_\_\_  
Object Ident. \_\_\_\_\_  
Ident. By \_\_\_\_\_  
*Signature*

DESCRIBE CORNER LOCATION RELATIVE TO NEAR-BY FEATURES, ALSO HOW TO REACH CORNER

Fence corner bears N. 72° E., 55.1 ft. Location poster at cattle guard on Rd # 2017-400, 605 ft. East of corner. Location poster on steel fence post in E/W fence line bears N. 22° E., 20.8 ft.

PLANE COORDINATE POSITION DATA

State \_\_\_\_\_ Zone \_\_\_\_\_  
X \_\_\_\_\_  
Y \_\_\_\_\_  
Estab. By \_\_\_\_\_  
*Agency*

Signature W. Ham Title LS2396 Division \_\_\_\_\_ Headquarters \_\_\_\_\_ Date 10/30/89 FS-7100-52 (3/68)

R. Vasquez, L. Day

**CORNER RECORD (PERPETUATION)**

MONUMENT: DESCRIBE NEW MONUMENT SET, OR WORK DONE TO PRESERVE EXISTING MONUMENT

Set ACAP 18" into ground,

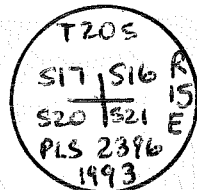

ACCESSORIES : DESCRIBE NEW BT'S WITNESS OBJECTS ETC. ESTABLISHED, OR WORK DONE TO PRESERVE EXISTING EVIDENCE

20" Juniper brs N 71 1/4° E @ 54.5' mkd T20S RISE S16 BT  
 3" " " S 11° E @ 79.1' " X BT  
 8" P. pine " S 64° W @ 384" " T20S RISE S20 BT  
 PR Nail in concrete on top of 2'x3'x11' Rock brs N 20 1/2° W @ 124.1'  
 Steel fence post brs West @ 2.8'

Work Done By Bill Ham Title PLS Date 5/93 State Registration No. 2396  
 or Agency

Certified Cor. Record Prepared?  Yes  No Filed At: Des Moines Co Date 5/18/93

GLO Survey of 1880 by F.W. Campbell REMARKS

Set stone 15X10X6 for corner to secs. 16, 17, 20 & 21 with pits as per instructions.

Index File No. T. R. M. Tract or Surv. No. Cor. 12 13

Index  
File No. 1163 (N-11)

CORNER RECORD (SEARCH)

(Ref. FSM 7151.4)

Tract or Survey No. \_\_\_\_\_  
Cor. No. N-11

T 20 S R. 15 E R.D. Ft. Rock County Deschutes

Merid. Willamette N.F. Deschutes State Oregon

CORNER DIAGRAM

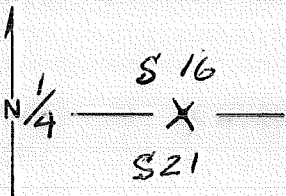

DESCRIBE CORNER MONUMENT FOUND

Original corner stone, marked  $\frac{1}{4}$  on N. face, in a mound of stone stone measures 23 x 14 x 6 ins.

DESCRIBE BEARING TREES OR OTHER OFFICIAL ACCESSORIES FOUND

PHOTO IDENTIFICATION DATA

Photo No. \_\_\_\_\_  
Filed At \_\_\_\_\_  
Object Ident. \_\_\_\_\_  
Ident. By \_\_\_\_\_  
Signature \_\_\_\_\_

DESCRIBE CORNER LOCATION RELATIVE TO NEAR-BY FEATURES, ALSO HOW TO REACH CORNER

Fence corner bears East, 176 ft. from corner, "Attention" sign on steel fence post bears East 8.6 ft.

PLANE COORDINATE POSITION DATA

State \_\_\_\_\_ Zone \_\_\_\_\_  
X \_\_\_\_\_  
Y \_\_\_\_\_  
Estab. By \_\_\_\_\_  
Agency \_\_\_\_\_

Signature W. Ham

R. Vasquez, L. Day

Title 652396 Division \_\_\_\_\_

Headquarters \_\_\_\_\_

Date \_\_\_\_\_

FS-7100-52 (3/68)

10/30/89

**CORNER RECORD (PERPETUATION)**

MONUMENT: DESCRIBE NEW MONUMENT SET, OR WORK DONE TO PRESERVE EXISTING MONUMENT

Set ACAP ~~18"~~ 18" in ground

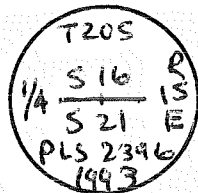

ACCESSORIES : DESCRIBE NEW BT'S WITNESS OBJECTS ETC. ESTABLISHED, OR WORK DONE TO PRESERVE EXISTING EVIDENCE

Rebar rising 16" brs S 89° E @ 176 2/3' w/AC mld RM2 TO 1/4 PLS  
 A 30" P. pine brs S 47 3/4° E @ 481 8/9 FT. MK'd 1/4 S21 BT 2396 1993

Rebar rising 18" brs S 28 1/2° W, @ 24 2/3' with AC mld RM3 to 1/4 PLS  
 A PK nail in 3' x 3' x 3' boulder brs N 5 1/2° W @ 65 1/2', 2396 1993

Stl Fence posts br East ~~at~~ and west @ 2 1/2'

Work Done By Bill Ham Title PLS Date 5/93 State Registration No. or Agency 2396

Certified Cor. Record Prepared?  Yes  No Filed At: Declarator Co. Date 5/18/93

GLO Survey of 1880. by F.W. Campbell

Set. Stone 18x10 x 4 for 1/4 sec. corner in mound of stone.

Index File No. T. R. M. Tract or Surv. No. Cor. 12 13

Index  
File No. 1363 (N-13)

**CORNER RECORD (SEARCH)**

(Ref. FSM 7151.4)

Tract or  
Survey No. \_\_\_\_\_

Cor.  
No. N-13

T 20 S R. 15 E

R.D. Ft. Rock

County Deschutes

Merid. Willamette

N.F. Deschutes

State Oregon

**CORNER DIAGRAM**

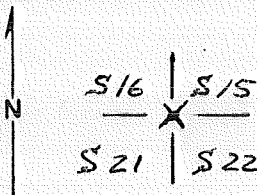

**DESCRIBE CORNER MONUMENT FOUND**

Stone 24x12x12 in a mound of stone

**DESCRIBE BEARING TREES OR OTHER OFFICIAL ACCESSORIES FOUND**

**PHOTO IDENTIFICATION DATA**

Photo No. \_\_\_\_\_

Filed At. \_\_\_\_\_

Object Ident. \_\_\_\_\_

Ident. By \_\_\_\_\_

*Signature*

**PLANE COORDINATE POSITION DATA**

State \_\_\_\_\_ Zone \_\_\_\_\_

X \_\_\_\_\_

Y \_\_\_\_\_

Estab. By \_\_\_\_\_

*Agency*

*Signature W Ham*

*R. Vasquez*

Title 2396 Division

Headquarters

Date

10/30/89

FS-7100-52 (3/68)



**CORNER RECORD (PERPETUATION)**

**MONUMENT: DESCRIBE NEW MONUMENT SET, OR WORK DONE TO PRESERVE EXISTING MONUMENT**

Set ACAP 24" in ground

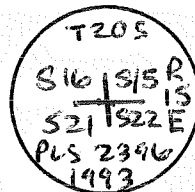

**ACCESSORIES: DESCRIBE NEW BT<sup>1/2</sup> WITNESS OBJECTS ETC. ESTABLISHED, OR WORK DONE TO PRESERVE EXISTING EVIDENCE**

4" P. pine brs N57 1/4° E @ 116' mkd X BT  
 2" " " S63 3/4° E @ 97' " X BT  
 20" P. pine " S53 1/2° W " 1045' " T205 R11E S21 BT  
 2" " " N.60° W @ 174' mkd X BT

Steel fence post brs 2.5' East and 3.2' West.

Work Done By Bill Ham Title PLS Date 5/93 State Registration No. 2396  
 or Agency

Certified Cor. Record Prepared?  Yes  No Filed At: Deschutes Co. Date 5/18/93

610 Survey of 1880 by F.W. Campbell REMARKS

Set stone 18 X 10 X 10 for corner to secs. 15, 16, 21 & 22, in mound of stone

Index File No. T. R. M. Tract or Surv. No. Cor. 12 13

USDA-FOREST SERVICE

Index File No. 1563 (N-15)

CORNER RECORD (SEARCH)

(Ref. FSM 7151.4)

Tract or Survey No. \_\_\_\_\_ Cor. No. N-15

T 20 E R. 15 E R.D. Ft. Rock County Deschutes S/A S. 15

Merid. Willamette N.F. Deschutes State Oregon

CORNER DIAGRAM

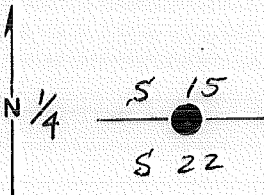

DESCRIBE CORNER MONUMENT FOUND

Searched 5 hours, chained in from sec. cor. to the East. - found 1 possible stone, Nothing identified for sure.

SFNF - 5/93

2

DESCRIBE BEARING TREES OR OTHER OFFICIAL ACCESSORIES FOUND

SFNF - 5/93

3

DESCRIBE CORNER LOCATION RELATIVE TO NEAR-BY FEATURES, ALSO HOW TO REACH CORNER

PHOTO IDENTIFICATION DATA

Photo No. \_\_\_\_\_  
Filed At. \_\_\_\_\_  
Object Ident. \_\_\_\_\_  
Ident. By \_\_\_\_\_  
*Signature*

6

7

PLANE COORDINATE POSITION DATA

State \_\_\_\_\_ Zone \_\_\_\_\_  
X \_\_\_\_\_  
Y \_\_\_\_\_  
Estab. By \_\_\_\_\_  
*Agency*

8

Signature *W Ham*  
*S. Keith R. Vasquez.*

Title \_\_\_\_\_ Division \_\_\_\_\_ Headquarters \_\_\_\_\_

Date 10/26/89

FS-7100-52 (3/68)

4

5

**CORNER RECORD (PERPETUATION)**

**MONUMENT: DESCRIBE NEW MONUMENT SET, OR WORK DONE TO PRESERVE EXISTING MONUMENT**

Set by single proportion an ACAP 24" into Ground

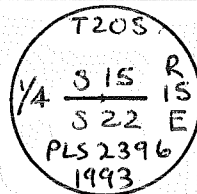

**ACCESSORIES : DESCRIBE NEW BT'S WITNESS OBJECTS ETC. ESTABLISHED, OR WORK DONE TO PRESERVE EXISTING EVIDENCE**

- A 3" PP brs N 20 1/2° E @ 42 1/2 ft. mkd X BT
- " 3" " " S 35 3/4° E @ 70 1/2 " " X BT
- " 7" " " S 10 1/2° W @ 18.3 ft " 1/4 ~~S 22~~ BT S 22 BT
- " 16" " " N 59° W @ 73 1/2 " " 1/4 S 15 BT

Work Done By Bill Ham Title PLS Date 5/93 State Registration No. 2396  
or Agency

Certified Cor. Record Prepared?  Yes  No Filed At: Deschutes Co. Date 5/18/93

660 Survey of 1880. by F.W. Campbell REMARKS

Set stone 15X12X12 for 1/4 sec. corner. with pits  
as per instructions,

Index File No. 1563 T.    R.    M.    Tract or Surv. No.    Cor. N45

USDA-FOREST SERVICE

Index File No. 1763

CORNER RECORD (SEARCH)

(Ref. FSM 7151.4)

Tract or Survey No. \_\_\_\_\_

Cor. No. N-17

T 20 S. R. 15 E.

R.D. Ft. Rock County Deschutes

NW Cor. Sec. 23

Merid. WMT

N.F. \_\_\_\_\_ State \_\_\_\_\_

CORNER DIAGRAM

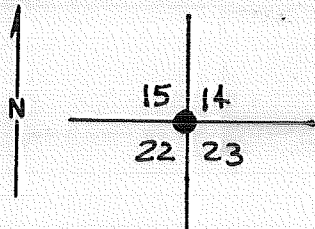

T20S, R15E

DESCRIBE CORNER MONUMENT FOUND

Original stone, 17" X 9" X 6" with 3 grooves on South & 2 grooves on East edges, set firmly in the ground.  
 A Ponderosa Pine windfall, 20" dia., S.31°W., 235 Lks., with burned & rotted face.  
 A Ponderosa Pine, 36" dia., N.58°15'E., 44 Lks. to burnt face with faint scribing visible.

PHOTO IDENTIFICATION DATA

Photo No. \_\_\_\_\_

Filed At. \_\_\_\_\_

Object Ident. \_\_\_\_\_

Ident. By \_\_\_\_\_

*Signature*

DESCRIBE CORNER LOCATION RELATIVE TO NEAR-BY FEATURES, ALSO HOW TO REACH CORNER

PLANE COORDINATE POSITION DATA

State \_\_\_\_\_ Zone \_\_\_\_\_

X \_\_\_\_\_

Y \_\_\_\_\_

Estab. By \_\_\_\_\_

*Agency*

Signature

William B. Ham

Title

PLS

Division

CS

Headquarters

SO

Date

12/92

FS-7100-52 (3/68)

USDA-FOREST SERVICE

Index File No. 1763

CORNER RECORD (SEARCH)

(Ref. FSM 7151.4)

Tract or Survey No. \_\_\_\_\_

Cor. No. N-17

T 20 S., R. 15 E.

R.D. Ft. Rock

County Deschutes

NW Cor Sec. 23

Merid. WMT

N.F. \_\_\_\_\_

State \_\_\_\_\_

CORNER DIAGRAM

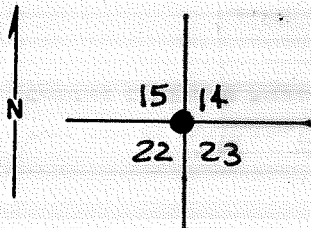

T20S, R15E

DESCRIBE CORNER MONUMENT FOUND

Original stone, 17" X 9" X 6" with 3 grooves on South & 2 grooves on East edges, set firmly in the ground.  
 A Ponderosa Pine windfall, 20" dia., S.31°W., 235 Lks., with burned & rotted face.  
 A Ponderosa Pine, 36" dia., N.58°15'E., 44 Lks. to burnt face with faint scribing visible.

PHOTO IDENTIFICATION DATA

Photo No. \_\_\_\_\_

Filed At. \_\_\_\_\_

Object Ident. \_\_\_\_\_

Ident. By \_\_\_\_\_

*Signature*

DESCRIBE CORNER LOCATION RELATIVE TO NEAR-BY FEATURES, ALSO HOW TO REACH CORNER

PLANE COORDINATE POSITION DATA

State \_\_\_\_\_ Zone \_\_\_\_\_

X \_\_\_\_\_

Y \_\_\_\_\_

Estab. By \_\_\_\_\_

*Agency*

Signature

William B. Ham

Title

PLS

Division

CS

Headquarters

SO

Date

12/92

FS-7100-52 (3/68)

### CORNER RECORD (PERPETUATION)

**MONUMENT: DESCRIBE NEW MONUMENT SET, OR WORK DONE TO PRESERVE EXISTING MONUMENT**

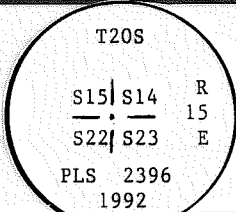

- A 2 1/2" dia. X 30" long aluminum pipe, surmounted by a 2 1/2" dia. alum. cap, 26" in the ground. Penny at base of pipe. Original stone buried alongside. Steel fence post East, 6 ft.
- A Ponderosa Pine, 36" dia., N.58°15'E., 30.0 ft., Orig. BT remarked T20S R15E S14 BT
- A Ponderosa Pine, 12" dia., S.32°15"E., 67.7 ft., marked T20S R15E S23 BT
- A 3" dia. brass disc in concrete post, S.84°45'W., 189.3 ft., marked USFS BENCH MARK EL. 4898 1929
- A Ponderosa Pine, 10" dia., N.13°W., 20.3 ft., marked T20S R15E S15 BT

**EXISTING EVIDENCE**

- Location poster & cruise mark on a Ponderosa Pine, 12" dia., S.10°45'W., 43.2 ft.
- Location poster on Observatory road approximately 275 ft. West.
- A brass washer marked PLS 2396 nailed between the B & T in the scribing.

Work Done By William B. Ham Title PLS Date 12/92 State Registration No. 2396  
 or Agency  
 Certified Cor. Record Prepared?  Yes No Filed At: Deschutes Co. Date 1/5/93

**REMARKS**

Survey Of 1880 by Meldrum, Moore & Campbell.  
 Set basalt stone 16 X 8 X 6 for corner to Secs. 14,15,22 & 23, from which  
 A Pine 20 in. diam. bears S.32°W., 234 lks. dist.  
 A Pine 20 " " " N.48°E., 40 lks. "

Index File No. T. R. M. Tract or Surv. No. Cor.

1763

N-17

Index  
File No. 1963 (N-19)

CORNER RECORD (SEARCH)

(Ref. FSM 7151.4)

Tract or  
Survey No. \_\_\_\_\_

Cor.  
No. N-19

T 20 S R. 15 E

R.D. Ft. Rock

County Deschutes

S/A S. 14

Merid. Willamette

N.F. Deschutes

State Ore

CORNER DIAGRAM

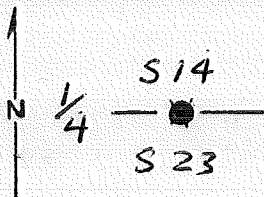

DESCRIBE CORNER MONUMENT FOUND

Original corner stone, 13x10x6 ins.,  
set firmly in the ground, marked  
 $\frac{1}{4}$  on East face; in a mound of stone.

DESCRIBE BEARING TREES OR OTHER OFFICIAL ACCESSORIES FOUND

No evidence of pits. Area has  
been overgrazed.

PHOTO IDENTIFICATION DATA

Photo No. \_\_\_\_\_

Filed At. \_\_\_\_\_

Object Ident. \_\_\_\_\_

Ident. By \_\_\_\_\_

Signature

PLANE COORDINATE POSITION DATA

State \_\_\_\_\_ Zone \_\_\_\_\_

X \_\_\_\_\_

Y \_\_\_\_\_

Estab. By \_\_\_\_\_

Agency

DESCRIBE CORNER LOCATION RELATIVE TO NEAR-BY FEATURES, ALSO HOW TO REACH CORNER

E/W. fence line bears south, 64.5 ft. from cor.

A location poster on a 4" dia. Juniper  
bears N. 35° E., 14.5 ft.

Location poster on W. side of Rd # 2017-100  
bears west, approx. 24 chs.

Signature W. Ham

Title 652396 Division

Headquarters

Date

10/25/89

FS-7100-52 (3/68)

R. Vasquez

**CORNER RECORD (PERPETUATION)**

MONUMENT: DESCRIBE NEW MONUMENT SET, OR WORK DONE TO PRESERVE EXISTING MONUMENT

Set ACAP 22" into ground.

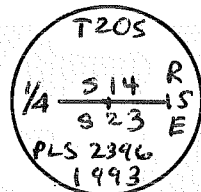

ACCESSORIES: DESCRIBE NEW BT<sup>1/2</sup> WITNESS OBJECTS ETC. ESTABLISHED, OR WORK DONE TO PRESERVE EXISTING EVIDENCE

4" Juniper brs ~~N 33 3/4° E 14.45 ft~~  
~~N 70 3/4° E, 31.5, mkd X BT~~  
~~20" P. pine " S 35 1/2° E, 32.2 ft " 1/4 S23 BT~~  
~~8" Juniper " S 42° W, 34.2 ft " 1/4 S23 BT~~  
~~7" " " S 42° W, 34.2 ft " 1/4 S23 BT~~  
~~16" P. pine " N 10° W 172.9 ft " 1/4 S14 BT~~  
~~Steel fence posts S, A' East and 4, 9' West~~

Work Done By: B. H. Ham Title: PLS Date: 5/93 State Registration No. 2396  
 or Agency \_\_\_\_\_  
 Certified Cor. Record Prepared?  Yes  No Filed At: Des. Co. Date: 5/18/93

REMARKS  
 GLO survey of 1880 by F.W. Campbell  
 Set Basalt stone 17x8x6 for 1/4 sec. corner with  
 pits as per instructions

Index File No. T. R. M. Tract or Surv. No. Cor.

1963

GPO: 1986 O-439-095

N-19



Index File No. 2163 (N-21)

**CORNER RECORD (SEARCH)**  
(Ref. FSM 7151.4)

Tract or Survey No. \_\_\_\_\_ Cor. No. N-21  
~~723~~

T 208 R. 15E R.D. Ft. Rock County Deschutes NW Cor. S, 24  
Merid. Willamette N.F. Deschutes State Oregon

CORNER DIAGRAM

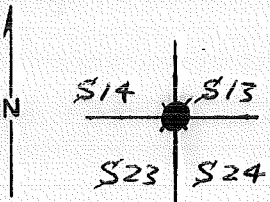

DESCRIBE CORNER MONUMENT FOUND

A stone 19 x 12 x 3 ins. with possible faint notches on S. & E. edges; in a mound of stone

DESCRIBE BEARING TREES OR OTHER OFFICIAL ACCESSORIES FOUND

PHOTO IDENTIFICATION DATA

Photo No. \_\_\_\_\_  
Filed At. \_\_\_\_\_  
Object Ident. \_\_\_\_\_  
Ident. By \_\_\_\_\_  
Signature \_\_\_\_\_

DESCRIBE CORNER LOCATION RELATIVE TO NEAR-BY FEATURES, ALSO HOW TO REACH CORNER

A cruise mark "f" on a 30" dia. P. pine bears S 24° W., 162 ft. N/S. Blaze line runs South out of corner. Old Property Bdy signs on trees west of corner. E/W fence line bears South, 118 ft from corner

PLANE COORDINATE POSITION DATA

State \_\_\_\_\_ Zone \_\_\_\_\_  
X \_\_\_\_\_  
Y \_\_\_\_\_  
Estab. By \_\_\_\_\_  
Agency \_\_\_\_\_

Signature W. Ham  
& R. Vasquez

Title 2396 Division \_\_\_\_\_ Headquarters \_\_\_\_\_

Date 10/25/89 FS-7100-52 (3/68)

**CORNER RECORD (PERPETUATION)**

**MONUMENT: DESCRIBE NEW MONUMENT SET, OR WORK DONE TO PRESERVE EXISTING MONUMENT**

Set ACAP 20" into ground

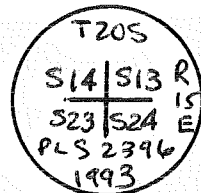

**ACCESSORIES: DESCRIBE NEW BT<sup>s</sup> WITNESS OBJECTS ETC. ESTABLISHED, OR WORK DONE TO PRESERVE EXISTING EVIDENCE**

A 4" dia. P. pine brs N 70<sup>3</sup>/<sub>4</sub>° E @ 31<sup>5</sup> ft mkd X BT  
 " 20" " " " S 67<sup>1</sup>/<sub>2</sub>° E @ 101<sup>9</sup> ft " T205 RISE S24 BT  
 " 25 " " " S 23<sup>1</sup>/<sub>4</sub>° W @ 15<sup>6</sup> ft " T205 RISE S23 BT  
 " 3" " " " N 15<sup>1</sup>/<sub>4</sub>° W @ 42<sup>0</sup> ft " X BT

Steel fence posts 3<sup>1</sup> ft North and 5<sup>2</sup> ft West

Work Done By Bill Ham Title PLS Date 5/93 State Registration No. 2396  
 or Agency

Certified Cor. Record Prepared?  Yes  No Filed At: Deer, County Date 5/18/93

GLO Survey of 1890 by FW Campbell REMARKS

Set stone 15" x 12" x 4" for corner to Secs. 13, 14, 23 & 24  
 in mound of stone

Index File No. T. R. M. Tract or Surv. No. Cor.

2163

GPO: 1986 O-439-095

N-21

Index  
File No. 2363 (N-23)

CORNER RECORD (SEARCH)

(Ref. FSM 7151.4)

Tract or  
Survey No. \_\_\_\_\_

Cor.  
No. N-23

T 20 S R. 15 E

R.D. Ft. Rock

County Deschutes

S/4 S.13

Merid. Willamette

N.F. Deschutes

State Oregon

CORNER DIAGRAM

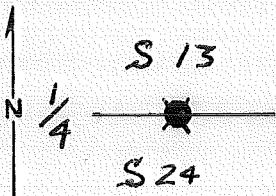

DESCRIBE CORNER MONUMENT FOUND

original cornerstone 39" X 16" X 32", leaning against North side of fence; marked  $\frac{1}{4}$  on South face

DESCRIBE BEARING TREES OR OTHER OFFICIAL ACCESSORIES FOUND

5 stones surround base of corner Stone.

PHOTO IDENTIFICATION DATA

Photo No. \_\_\_\_\_

Filed At \_\_\_\_\_

Object Ident. \_\_\_\_\_

Ident. By \_\_\_\_\_

*Signature*

PLANE COORDINATE POSITION DATA

State \_\_\_\_\_ Zone \_\_\_\_\_

X \_\_\_\_\_

Y \_\_\_\_\_

Estab. By \_\_\_\_\_

*Agency*

Signature W. Ham

Title S 2396

Division \_\_\_\_\_

Headquarters \_\_\_\_\_

Date

10-25-89

FS-7100-52 (3/68)

CORNER RECORD (PERPETUATION)

MONUMENT: DESCRIBE NEW MONUMENT SET, OR WORK DONE TO PRESERVE EXISTING MONUMENT

Set ACAP 24" into ground.

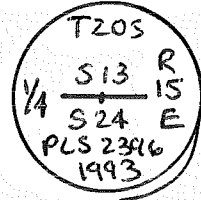

ACCESSORIES : DESCRIBE NEW BT<sup>s</sup> WITNESS OBJECTS ETC. ESTABLISHED, OR WORK DONE TO PRESERVE EXISTING EVIDENCE

A 3" dia P. pine brs N 60° E @ 92<sup>5</sup> ft, mkd X BT

A rebar rising 1" brs S 44<sup>3/4</sup>° E @ 23<sup>3</sup> ft w/AC MKD B01 S24 PLS 2396 1993

A 6" dia P. pine brs S 61° W @ 59° ft mkd 1/4 S24 BT

A rebar rising 12" brs N 42<sup>3/4</sup>° W @ 23<sup>7</sup> ft w/AC MKD B02 S~~23~~ PLS 2396 1993

A steel fence post brs 3' East

Work Done By Bill Ham Title PLS Date 5/93 State Registration No. 2394  
or Agency

Certified Cor. Record Prepared?  Yes No Filed At: Des. Co. Date 5/18/93

Survey of 1880. - GLO Notes REMARKS by F.W. Campbell  
@ 40.18 chs. "Set stone 36X12X6 for 1/4 sec corner in  
mound of stone."

Index File No. T. R. M. Tract or Surv. No. Cor.

2363

N-23 13

Index

File No. 2563 (N-25)

CORNER RECORD (SEARCH)

(Ref. FSM 7151.4)

Tract or

Survey No. \_\_\_\_\_

Cor.

No. N-25

T 20S R. 15E R.D. Fort Rock County Deschutes NW COR

Merid. Willamette N.F. Deschutes State Ore. S19

CORNER DIAGRAM

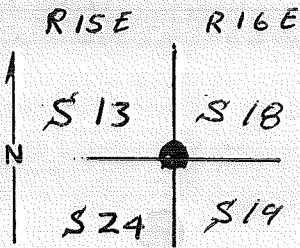

DESCRIBE CORNER MONUMENT FOUND

Stone 25 X 16 X 6 ins. in a mound of stone.

DESCRIBE BEARING TREES OR OTHER OFFICIAL ACCESSORIES FOUND

PHOTO IDENTIFICATION DATA

Photo No. \_\_\_\_\_

Filed At. \_\_\_\_\_

Object Ident. \_\_\_\_\_

Ident. By \_\_\_\_\_

Signature

PLANE COORDINATE POSITION DATA

State \_\_\_\_\_ Zone \_\_\_\_\_

X \_\_\_\_\_

Y \_\_\_\_\_

Estab. By \_\_\_\_\_

Agency

DESCRIBE CORNER LOCATION RELATIVE TO NEAR-BY FEATURES, ALSO HOW TO REACH CORNER

S. 80° W., 7.5 ft to fence corner.

Signature W. Ham Title LS 2396 Division \_\_\_\_\_

S. Keith, R. Vasquez

Headquarters \_\_\_\_\_

Date

10/26/89

FS-7100-52 (3/68)

**CORNER RECORD (PERPETUATION)**

MONUMENT: DESCRIBE NEW MONUMENT SET, OR WORK DONE TO PRESERVE EXISTING MONUMENT

Set ACAP 18" into ground

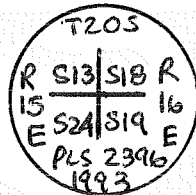

ACCESSORIES : DESCRIBE NEW BT & WITNESS OBJECTS ETC. ESTABLISHED, OR WORK DONE TO PRESERVE EXISTING EVIDENCE

- A 18" Juniper brs N 72 1/4° E @ 263<sup>±</sup> ft mkd T20S R 16 E S 18 BT
- A 9" " " S 76° E @ 135<sup>±</sup> " " T20S R 16 E S 19 BT
- A 10" " " S 26° W @ 95<sup>±</sup> " " T20S R 15 E S 24 BT
- A 9" " " N 16 1/2° W @ 123<sup>±</sup> " " T20S R 15 E S 13 BT

A steel fence post brs 6 1/2' west

Work Done By Bill Ham Title PLS Date 5/93 State Registration No. 2396  
or Agency

Certified Cor. Record Prepared?  Yes No Filed At: Des Co. Date 5/18/93

GLO Survey of 1877 by Alonzo Gesnen REMARKS

Set stone 25 X 6 X 5 for cor. to Secs. 18, 19, 13 & 24.  
Raised stone mound at cor.

Index File No. T. R. M. Tract or Surv. No. Cor.

2563

Index  
File No. 0165

CORNER RECORD (SEARCH)

(Ref. FSM 7151.4)

Tract or Survey No. \_\_\_\_\_ Cor. No. P-1

T 208 R. 15E

R.D. Ft. Rock County Deschutes

Merid. Willamette

N.F. Deschutes State Oregon

CORNER DIAGRAM

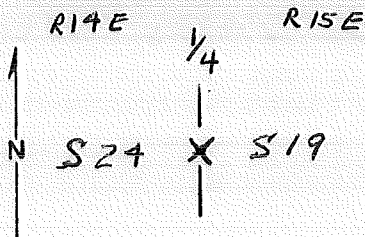

DESCRIBE CORNER MONUMENT FOUND

original stone 15X12X4, marked  $\frac{1}{4}$  on west face

DESCRIBE BEARING TREES OR OTHER OFFICIAL ACCESSORIES FOUND

PHOTO IDENTIFICATION DATA

Photo No. \_\_\_\_\_  
Filed At \_\_\_\_\_  
Object Ident. \_\_\_\_\_  
Ident. By \_\_\_\_\_  
*Signature*

DESCRIBE CORNER LOCATION RELATIVE TO NEAR-BY FEATURES, ALSO HOW TO REACH CORNER

N/S fence line bears West 50 ft.  
Attention sign on steel fence post bears South, 30 ft. mound of stones built around base of fence post.

PLANE COORDINATE POSITION DATA

State \_\_\_\_\_ Zone \_\_\_\_\_  
X \_\_\_\_\_  
Y \_\_\_\_\_  
Estab. By \_\_\_\_\_  
*Agency*

Signature W Ham  
R. Vasquez & Lo Day

Title 22396 Division

Headquarters

Date 10-31-89

FS-7100-52 (3/68)

CORNER RECORD (PERPETUATION)

MONUMENT: DESCRIBE NEW MONUMENT SET, OR WORK DONE TO PRESERVE EXISTING MONUMENT

9

ACCESSORIES : DESCRIBE NEW BT<sup>1</sup>/<sub>2</sub> WITNESS OBJECTS ETC. ESTABLISHED, OR WORK DONE TO PRESERVE EXISTING EVIDENCE

10

Work Done By \_\_\_\_\_ Title \_\_\_\_\_ Date \_\_\_\_\_ State Registration No. or Agency \_\_\_\_\_

Certified Cor. Record Prepared? Yes No Filed At: \_\_\_\_\_ Date \_\_\_\_\_

11

GLO Survey of 1880 by F.W. Campbell REMARKS

Set Basalt stone 16x15x4 for 1/4 sec. corner with pits as per instructions.

12

Index File No. T. R. M. Tract or Surv. No. Cor. 13



USDA-FOREST SERVICE

Index

File No. \_\_\_\_\_

CORNER RECORD (SEARCH)

(Ref. FSM 7151.4)

Tract or Survey No. \_\_\_\_\_

Cor. No. P-21

T 20 N R. 15 E

R.D. Bend

County Deschutes

Merid. Willamette

N.F. Deschutes

State ORE

CORNER DIAGRAM

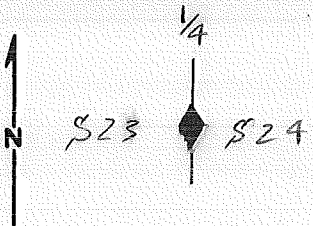

DESCRIBE CORNER MONUMENT FOUND

S F N F

Position falls in an old landing

2

DESCRIBE BEARING TREES OR OTHER OFFICIAL ACCESSORIES FOUND

End NE BT - A P. pine 34" dia w/  
Scribing visible on N. edge of spur Rd.  
at old landing site  
No evidence of NW BT.  
Extensive logging activity in the area.

3

PHOTO IDENTIFICATION DATA

Photo No. \_\_\_\_\_

Filed At. \_\_\_\_\_

Object Ident. \_\_\_\_\_

Ident. By \_\_\_\_\_

Signature

6

7

PLANE COORDINATE POSITION DATA

State \_\_\_\_\_ Zone \_\_\_\_\_

X \_\_\_\_\_

Y \_\_\_\_\_

Estab. By \_\_\_\_\_

Agency

8

DESCRIBE CORNER LOCATION RELATIVE TO NEAR-BY FEATURES, ALSO HOW TO REACH CORNER

Signature WH

Title LS Division

Headquarters

Date 4/93 FS-7100-52 (3/68)

4

5

### CORNER RECORD (PERPETUATION)

**MONUMENT: DESCRIBE NEW MONUMENT SET, OR WORK DONE TO PRESERVE EXISTING MONUMENT**

5/8" Rebar, 30" long driven flush with ground,  
in concrete, surmounted by a 3" dia. Alum.  
Cap; in a mound of stone. Penny under cap.

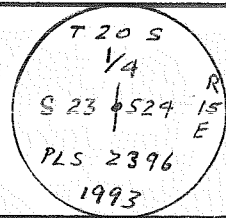

6' Fence post 2 ft. North

**ACCESSORIES : DESCRIBE NEW BT'S WITNESS OBJECTS ETC. ESTABLISHED, OR WORK DONE TO PRESERVE EXISTING EVIDENCE**

P. Pine 3 1/4" dia N. 60° E., 36.3 ft., - orig BT.  
P. Pine 4" dia S. 32° E., 43.0 ft., mkd X B.T  
P. Pine 5" dia S. 35° W., 37.6 ft., mkd X B.T  
P. Pine 6" dia N. 83° W., 9.4 ft., mkd V 4 S 23 B.T  
Brass washer mkd PLS 2396 nailed between B & T in scribing

Work Done By WJ Title LS Date 4/25/93 State Registration No. 2396  
or Agency

Certified Cor. Record Prepared?  Yes  No Filed At: \_\_\_\_\_ Date 4/27/93

REMARKS

Index File No. T. R. M. Tract or Surv. No. Cor. 12  
13

## Section Line Marker Record

Fire Rd. Road or Trail Fort Rock District \_\_\_\_\_

Sec. Line between 21 & 28 T. 20 S. R. 15 E. \_\_\_\_\_

Sec. \_\_\_\_\_ Cor. 250 Ft. E  
¼ or Sec. feet N. S. E. or W.

Posted on S side Rd  
N. S. E. or W. R. or T.

Posted 7/17/52 By M. L. C.  
Date

(Approx. X)

Cor. Found (Exact. \_\_\_\_\_)

(Paced X)

Distance (Chained \_\_\_\_\_)

|    |    |    |    |    |    |
|----|----|----|----|----|----|
| 6  | 5  | 4  | 3  | 2  | 1  |
| 7  | 8  | 9  | 10 | 11 | 12 |
| 18 | 17 | 16 | 15 | 14 | 13 |
| 19 | 20 | 21 | 22 | 23 | 24 |
| 30 | 29 | 28 | 27 | 26 | 25 |
| 31 | 32 | 33 | 34 | 35 | 36 |

Indicate position of marker by  
red X

If marker is on Twp. or Rge. line, reference TWP. NORTH or Rge. EAST of that line.

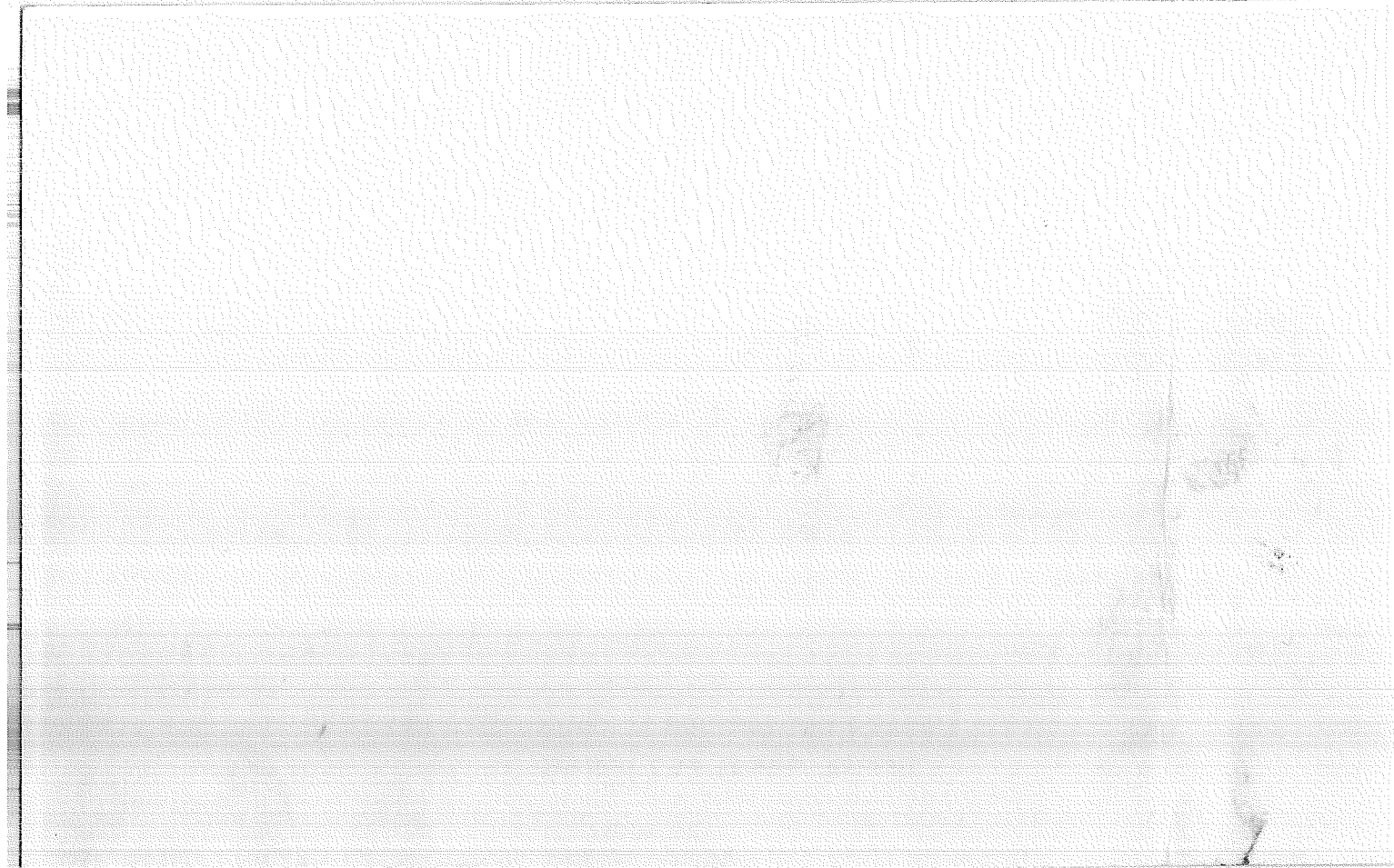

## Section Line Marker Record

2012 Pine Mtn. Road or Trail Fort Rock District

Sec. Line between 22 & 27 T. 20 S. R. 15 E.

$\frac{1}{4}$  Cor. 822 Ft. E  
 $\frac{1}{4}$  or Sec. feet N. S. E. or W.

Posted on S side Rd  
N. S. E. or W. R. or T.

Posted 7/9/52 By M. L. C.  
Date

(Approx. )

Cor. Found (Exact. \_\_\_\_\_)

(Paced )

Distance (Chained \_\_\_\_\_)

|    |    |    |    |    |    |
|----|----|----|----|----|----|
| 6  | 5  | 4  | 3  | 2  | 1  |
| 7  | 8  | 9  | 10 | 11 | 12 |
| 18 | 17 | 16 | 15 | 14 | 13 |
| 19 | 20 | 21 | 22 | 23 | 24 |
| 30 | 29 | 28 | 27 | 26 | 25 |
| 31 | 32 | 33 | 34 | 35 | 36 |

Indicate position of marker by  
red X

If marker is on Twp. or Rge. line, reference TWP. NORTH or Rge. EAST of that line.

marked with X on tree South side of road.



## Section Line Marker Record

Fire Road Road or Trail Fort Rock District

Sec. Line between 27 & 26 T. 20 S. R. 15 E.

Sec. 1155 Cor. N Ft. N  
¼ or Sec. feet N. S. E. or W.

Posted on N side Rd  
N. S. E. or W. R. or T.

Posted 7/17/52 By M. L. C.  
Date

(Approx. \_\_\_\_\_)

Cor. Found (Exact. X)

(Paced X)

Distance (Chained \_\_\_\_\_)

|    |    |    |    |    |    |
|----|----|----|----|----|----|
| 6  | 5  | 4  | 3  | 2  | 1  |
| 7  | 8  | 9  | 10 | 11 | 12 |
| 18 | 17 | 16 | 15 | 14 | 13 |
| 19 | 20 | 21 | 22 | 23 | 24 |
| 30 | 29 | 28 | 27 | 26 | 25 |
| 31 | 32 | 33 | 34 | 35 | 36 |

Indicate position of marker by  
red X

If marker is on Twp. or Rge. line, reference TWP. NORTH or Rge. EAST of that line.

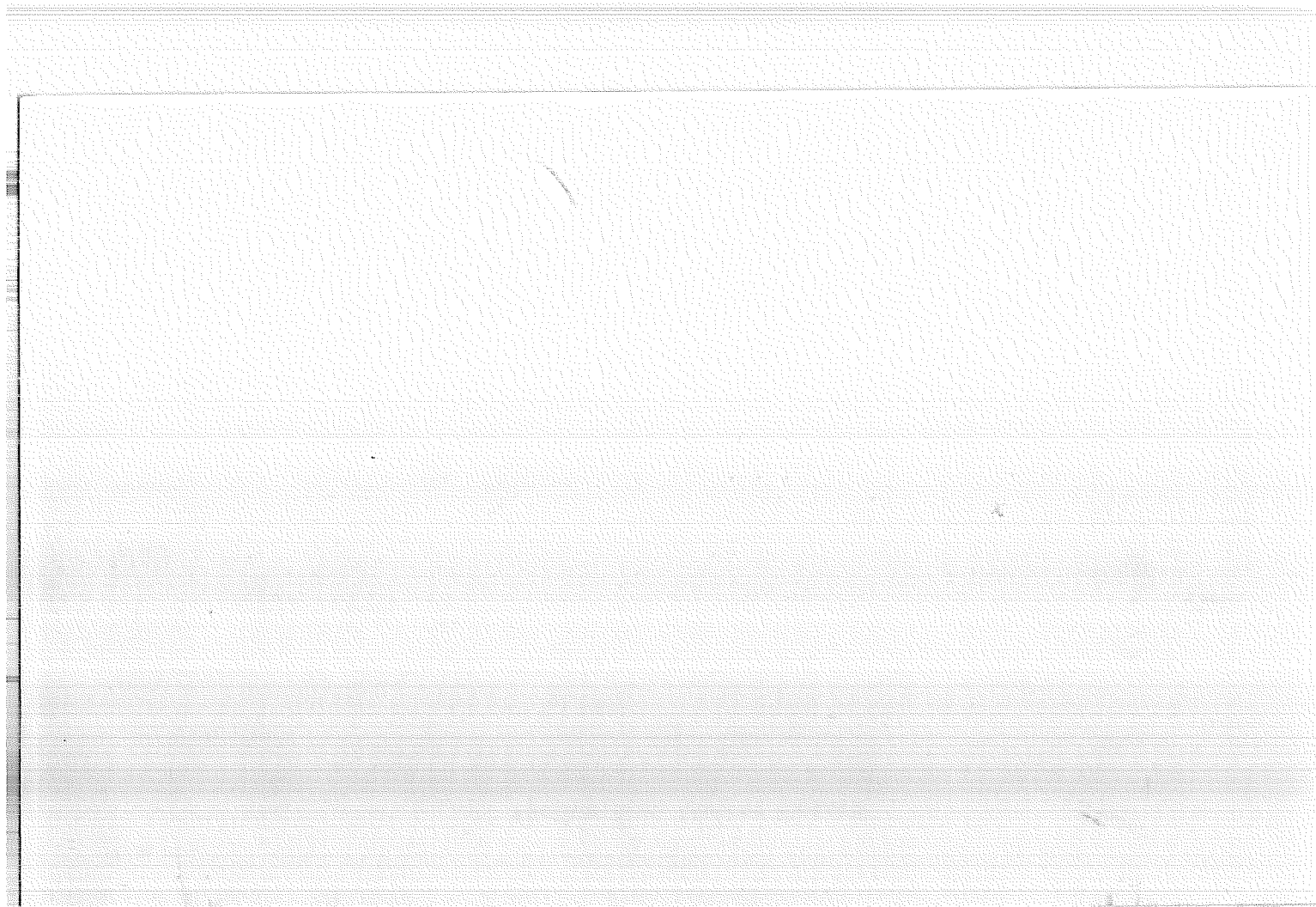



## Section Line Marker Record

#2012A East Basin Pine Mtn. Road or Trail Fort Rock District

Sec. Line between 26 & 25 T. 20 S. R. 15 E.

Sec. Cor. 495 Ft. N  
 ¼ or Sec. feet N. S. E. or W.

Posted on N side Rd  
 N. S. E. or W. R. or T.

Posted 7/15/52 By M. L. C.  
 Date

(Approx. \_\_\_\_\_)

Cor. Found (Exact. X \_\_\_\_\_)

(Paced X \_\_\_\_\_)

Distance (Chained \_\_\_\_\_)

|    |    |    |    |    |    |
|----|----|----|----|----|----|
| 6  | 5  | 4  | 3  | 2  | 1  |
| 7  | 8  | 9  | 10 | 11 | 12 |
| 18 | 17 | 16 | 15 | 14 | 13 |
| 19 | 20 | 21 | 22 | 23 | 24 |
| 30 | 29 | 28 | 27 | 26 | 25 |
| 31 | 32 | 33 | 34 | 35 | 36 |

Indicate position of marker by  
 red X

If marker is on Twp. or Rge. line, reference TWP. NORTH or Rge. EAST of that line.



## Section Line Marker Record

2012A East Basin kPine Mtn. Road or Trail Fort Rock District

Sec. Line between 24 & 25 T. 20 S. R. 15 E.

Sec. Cor. 1115 Ft. W  
¼ or Sec. feet N. S. E. or W.

Posted on E side Rd  
N. S. E. or W. R. or T.

Posted 7/15/52 By M. L. C.  
Date

(Approx. \_\_\_\_\_)

Cor. Found (Exact. )

(Paced )

Distance (Chained \_\_\_\_\_)

|    |    |    |    |    |    |
|----|----|----|----|----|----|
| 6  | 5  | 4  | 3  | 2  | 1  |
| 7  | 8  | 9  | 10 | 11 | 12 |
| 18 | 17 | 16 | 15 | 14 | 13 |
| 19 | 20 | 21 | 22 | 23 | 24 |
| 30 | 29 | 28 | 27 | 26 | 25 |
| 31 | 32 | 33 | 34 | 35 | 36 |

Indicate position of marker by  
red X

If marker is on Twp. or Rge. line, reference TWP. NORTH or Rge. EAST of that line.

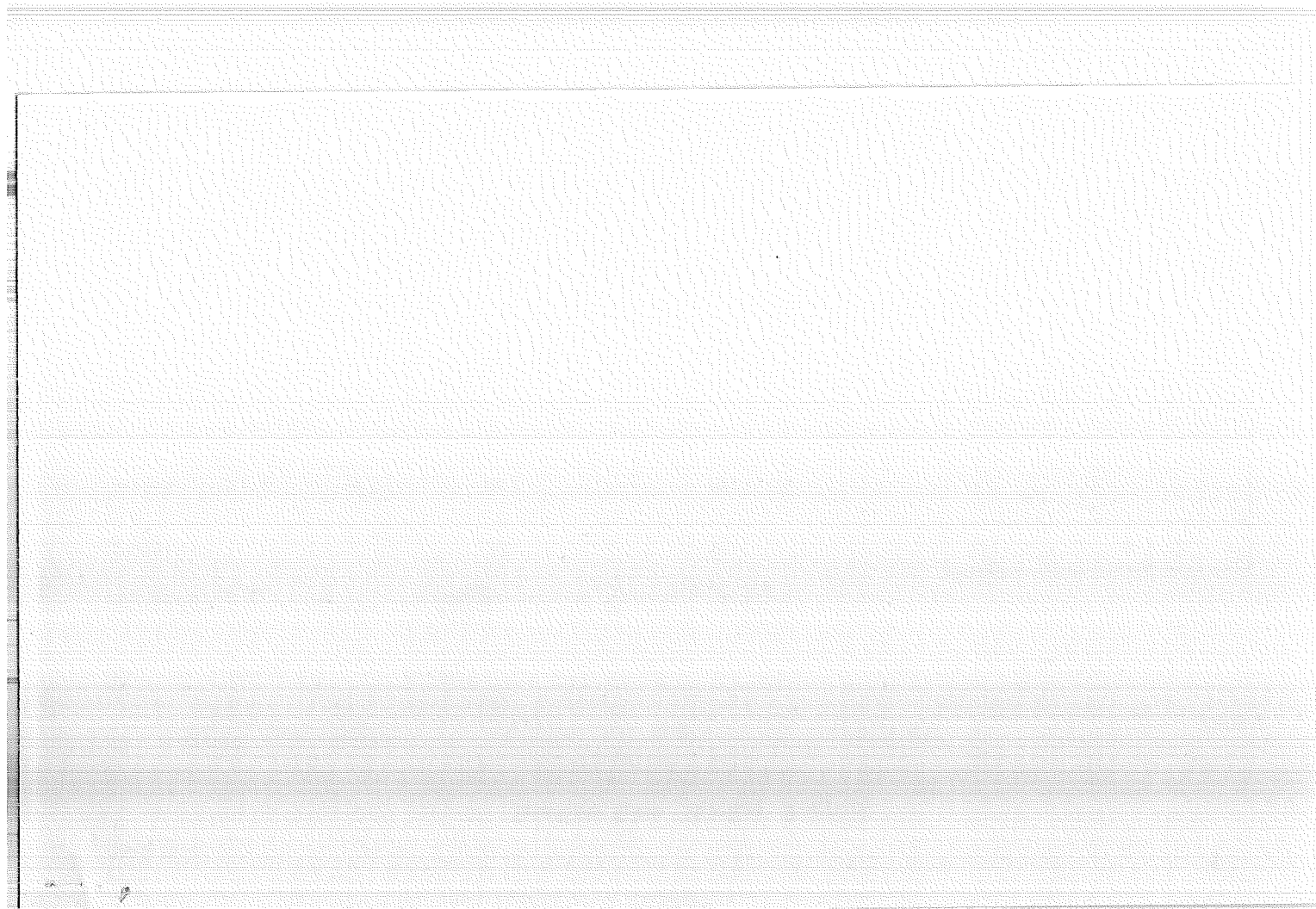

### Section Line Marker Record

2012 Pine Mtn. Road or Trail Fort Rock District

Sec. Line between 27 & 28 T. 20 S. R. 15 E.

$\frac{1}{4}$  Cor. 420 Ft. N  
 $\frac{1}{4}$  or Sec. feet N. S. E. or W.

Posted on N side Rd  
N. S. E. or W. R. or T.

Posted 7/9/52 By M. L. C.  
Date

(Approx. X)

Cor. Found (Exact. \_\_\_\_\_)

(Paced X)

Distance (Chained \_\_\_\_\_)

|    |    |    |                  |    |    |
|----|----|----|------------------|----|----|
| 6  | 5  | 4  | 3                | 2  | 1  |
| 7  | 8  | 9  | 10               | 11 | 12 |
| 18 | 17 | 16 | 15               | 14 | 13 |
| 19 | 20 | 21 | 22               | 23 | 24 |
| 30 | 29 | 28 | <del>28</del> 27 | 26 | 25 |
| 31 | 32 | 33 | 34               | 35 | 36 |

Indicate position of marker by red X

If marker is on Twp. or Rge. line, reference TWP. NORTH or Rge. EAST of that line.



Index File No. \_\_\_\_\_

**CORNER RECORD (SEARCH)**

(Ref. FSM 7151.4)

Tract or Survey No. \_\_\_\_\_

Cor. No. V-09

T 205 R. 15E

R.D. Bud/ft Rock County Deschutes

Merid. Willamette

N.F. Deschutes State OR

NW S. 33

**CORNER DIAGRAM**

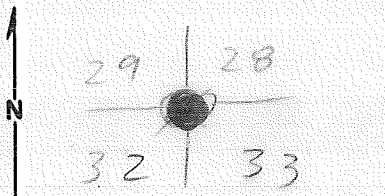

**DESCRIBE CORNER MONUMENT FOUND**

S F N F

**DESCRIBE BEARING TREES OR OTHER OFFICIAL ACCESSORIES FOUND**

cut off pp. stamp 17 "dia. - 5' high with faint scribbling. NEBT - set cor @ 6' 0" Brg & Dist from THIS TREE.  
 PP 31 "dia S 71° W 39° Ft. with face scribbling visible  
 By persons unknown - scribbling reads R15 T20 S32

**PHOTO IDENTIFICATION DATA**

Photo No. \_\_\_\_\_  
 Filed At \_\_\_\_\_  
 Object Ident. \_\_\_\_\_  
 Ident. By \_\_\_\_\_

Signature \_\_\_\_\_

**PLANE COORDINATE POSITION DATA**

State \_\_\_\_\_ Zone \_\_\_\_\_  
 X \_\_\_\_\_  
 Y \_\_\_\_\_  
 Estab. By \_\_\_\_\_

Agency \_\_\_\_\_

**DESCRIBE CORNER LOCATION RELATIVE TO NEAR-BY FEATURES, ALSO HOW TO REACH CORNER**

Tag on Ridge line 400' E. of cor.  
 N 50° W 450' From cattle guard on 400 Rd - which is approx 200 Ft west of the set w/ the 2017 Rd.  
 N 440 Ft. From Loc. Tag on N side of Rd 2017-400

Signature WY PSD

Title \_\_\_\_\_

Division \_\_\_\_\_

Headquarters \_\_\_\_\_

Date \_\_\_\_\_

FS-7100-52 (3/68)

5/23/02

### CORNER RECORD (PERPETUATION)

**MONUMENT: DESCRIBE NEW MONUMENT SET, OR WORK DONE TO PRESERVE EXISTING MONUMENT**

Set a 2 1/2" dia X 30" long steel pipe surmounted by a 2 1/2" dia brass cap rising 6" in a mound of stone.  
A penny @ base of pipe.

T20SR15E

S29 | S28

S32 | S33

PLS 2396

2002

Steel FP 3' N,

**ACCESSORIES : DESCRIBE NEW BT'S WITNESS OBJECTS ETC. ESTABLISHED, OR WORK DONE TO PRESERVE EXISTING EVIDENCE**

Orig BT A P.P. stamp 5' high - 17" dia bears N33°E 63.4 ft. to nail @ Chaining Notch. 1/2" dia Brass washer mkt'd LS 2396 nailed above mag nail.

PP 11" dia. S 87° E 24.2 ft. to mag nail @ side Center; mkt'd T20SR15E S33BT

PP 31" dia S 71° W 39.0 ft. " " " " " " Not remarked.

PP 16" dia N 12° W 22.7 ft. " " " " " " mkt'd T20SR15E S29BT 10

Work Done By WH PJD Title \_\_\_\_\_ Date 5/23/02 State Registration No. \_\_\_\_\_ or Agency \_\_\_\_\_

Certified Cor. Record Prepared?  Yes No Filed At: Deschutes Co. Date 6/12/02 ii

Survey ab 1880 by Melvin Moore & Campbell

**REMARKS**

Set post

A line 18 N33°E 96.0 ft 63.4 ft

A line 20 S60°W 25.0 ft 16.5 ft

Index File No. T. R. M. Tract or Surv. No. Cor. 12 13



## Section Line Marker Record

#2012B West Basin Pine Mtn.  
Road or Trail Fort Rock District

Sec. Line between 29 & 32 T. 20 S. R. 15 E.

Sec. Cor. 2145 Ft. E  
¼ or Sec. feet N. S. E. or W.

Posted on N side R  
N. S. E. or W. R. or T.

Posted 7/15/52 By M. L. C.  
Date

(Approx. \_\_\_\_\_)

Cor. Found (Exact. X)

(Paced \_\_\_\_\_ X)

Distance (Chained \_\_\_\_\_)

|    |    |    |    |    |    |
|----|----|----|----|----|----|
| 6  | 5  | 4  | 3  | 2  | 1  |
| 7  | 8  | 9  | 10 | 11 | 12 |
| 18 | 17 | 16 | 15 | 14 | 13 |
| 19 | 20 | 21 | 22 | 23 | 24 |
| 30 | 29 | 28 | 27 | 26 | 25 |
| 31 | 32 | 33 | 34 | 35 | 36 |

Indicate position of marker by  
red X

If marker is on Twp. or Rge. line, reference TWP. NORTH or Rge. EAST of that line.

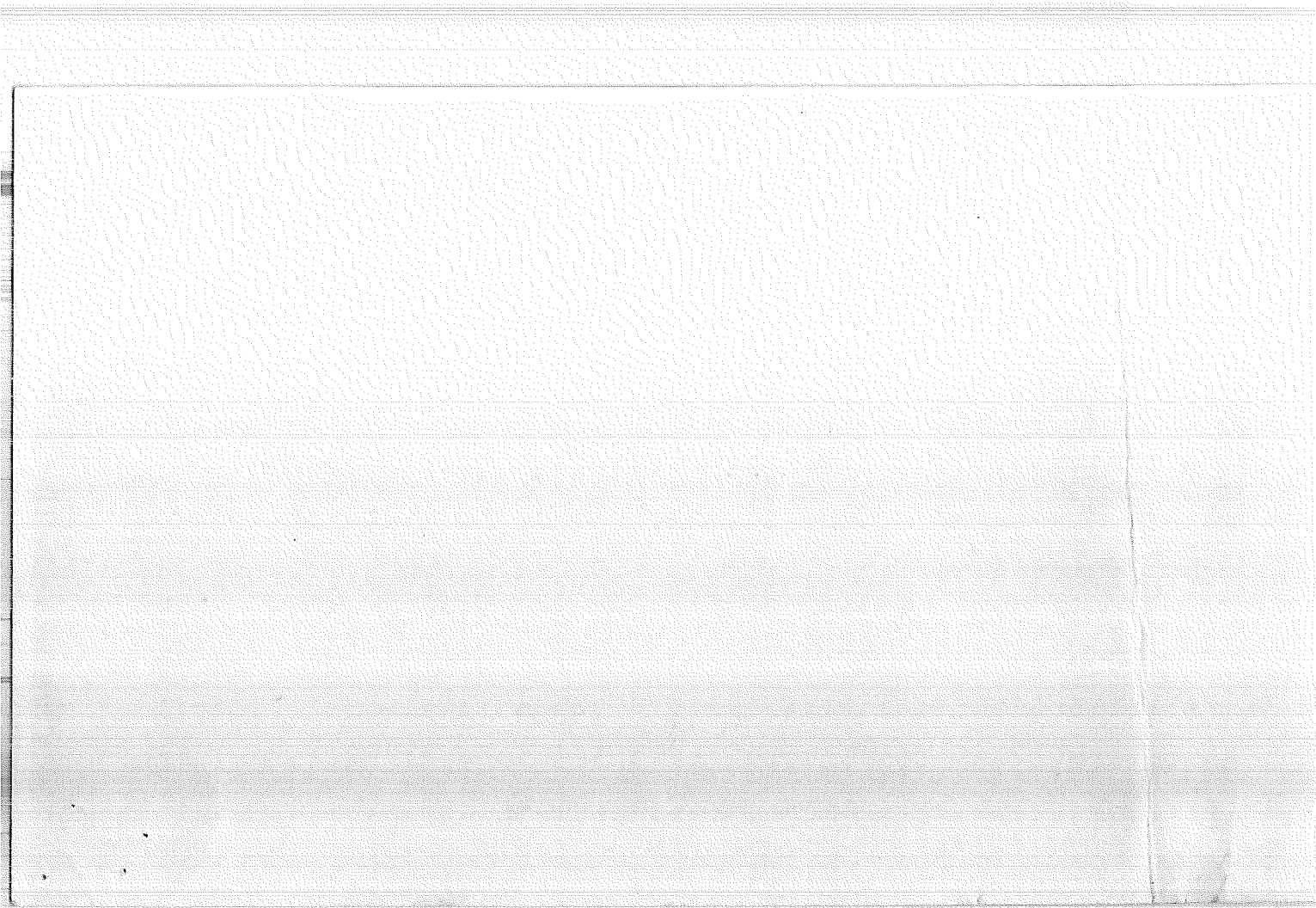

## Section Line Marker Record

#2012B West Basin Pine Mtn. District  
 Road or Trail Fort Rock

Sec. Line between 32 & 33 T. 20 S. R. 15 E.

Sec. Cor. 485 Ft. N  
 1/4 or Sec. feet N. S. E. or W.

Posted on N side Rd  
 N. S. E. or W. N. or T.

Posted 7/16/52 By M. L. C.  
 Date

(Approx. \_\_\_\_\_)

Cor. Found (Exact.  \_\_\_\_\_)

(Paced  \_\_\_\_\_)

Distance (Chained \_\_\_\_\_)

|    |    |    |    |    |    |
|----|----|----|----|----|----|
| 6  | 5  | 4  | 3  | 2  | 1  |
| 7  | 8  | 9  | 10 | 11 | 12 |
| 18 | 17 | 16 | 15 | 14 | 13 |
| 19 | 20 | 21 | 22 | 23 | 24 |
| 30 | 29 | 28 | 27 | 26 | 25 |
| 31 | 32 | 33 | 34 | 35 | 36 |

Indicate position of marker by  
 red X

If marker is on Twp. or Rge. line, reference TWP. NORTH or Rge. EAST of that line.



## Section Line Marker Record

2012 Pine Mtn. Road or Trail Fort Rock District

Sec. Line between 28 & 33 T. 20 S. R. 15 E.

Sec. \_\_\_\_\_ Cor. 680 Ft. W  
1/4 or Sec. feet N. S. E. or W.

Posted on W side Rd  
N. S. E. or W. R. or T.

Posted 7/16/52 By M. L. C.  
Date

(Approx. \_\_\_\_\_)

Cor. Found (Exact. )

(Paced )

Distance (Chained \_\_\_\_\_)

|    |    |    |    |    |    |
|----|----|----|----|----|----|
| 6  | 5  | 4  | 3  | 2  | 1  |
| 7  | 8  | 9  | 10 | 11 | 12 |
| 18 | 17 | 16 | 15 | 14 | 13 |
| 19 | 20 | 21 | 22 | 23 | 24 |
| 30 | 29 | 28 | 27 | 26 | 25 |
| 31 | 32 | 33 | 34 | 35 | 36 |

Indicate position of marker by  
 red X

If marker is on Twp. or Rge. line, reference TWP. NORTH or Rge. EAST of that line.

1871  
1872  
1873  
1874  
1875  
1876  
1877  
1878  
1879  
1880  
1881  
1882  
1883  
1884  
1885  
1886  
1887  
1888  
1889  
1890  
1891  
1892  
1893  
1894  
1895  
1896  
1897  
1898  
1899  
1900

## Section Line Marker Record

2012 Pine Mtn. Road or Trail Fort Rock District

Sec. Line between 28 & 33 T. 20 S. R. 15 E.

$\frac{1}{4}$  Cor. 135 Ft. W  
 $\frac{1}{4}$  or Sec. feet N. S. E. or W.

Posted on E side R  
N. S. E. or W. N. or T.

Posted 7/9/52 By M. L. C.  
Date

(Approx. )

Cor. Found (Exact. \_\_\_\_\_)

(Paced )

Distance (Chained \_\_\_\_\_)

|    |    |    |    |    |    |
|----|----|----|----|----|----|
| 6  | 5  | 4  | 3  | 2  | 1  |
| 7  | 8  | 9  | 10 | 11 | 12 |
| 18 | 17 | 16 | 15 | 14 | 13 |
| 19 | 20 | 21 | 22 | 23 | 24 |
| 30 | 29 | 28 | 27 | 26 | 25 |
| 31 | 32 | 33 | 34 | 35 | 36 |

Indicate position of marker by  
red X

If marker is on Twp. or Rge. line, reference TWP. NORTH or Rge. EAST of that line.





## Section Line Marker Record

2012 Pine Mtn. Road or Trail Fort Rock District \_\_\_\_\_

Sec. Line between 28 & 33 T. 20 S. R. 15 E. \_\_\_\_\_

1/4 Cor. 620 Ft. E  
¼ or Sec. feet N. S. E. or W.

Posted on E side Rd  
N. S. E. or W. R. or T.

Posted 7/9/52 By M. L. C.  
Date

(Approx. X

Cor. Found (Exact. \_\_\_\_\_

(Paced X

Distance (Chained \_\_\_\_\_

|    |    |                |    |    |    |
|----|----|----------------|----|----|----|
| 6  | 5  | 4              | 3  | 2  | 1  |
| 7  | 8  | 9              | 10 | 11 | 12 |
| 18 | 17 | 16             | 15 | 14 | 13 |
| 19 | 20 | 21             | 22 | 23 | 24 |
| 30 | 29 | 28<br><u>X</u> | 27 | 26 | 25 |
| 31 | 32 | 33             | 34 | 35 | 36 |

Indicate position of marker by  
red X

If marker is on Twp. or Rge. line, reference TWP. NORTH or Rge. EAST of that line.

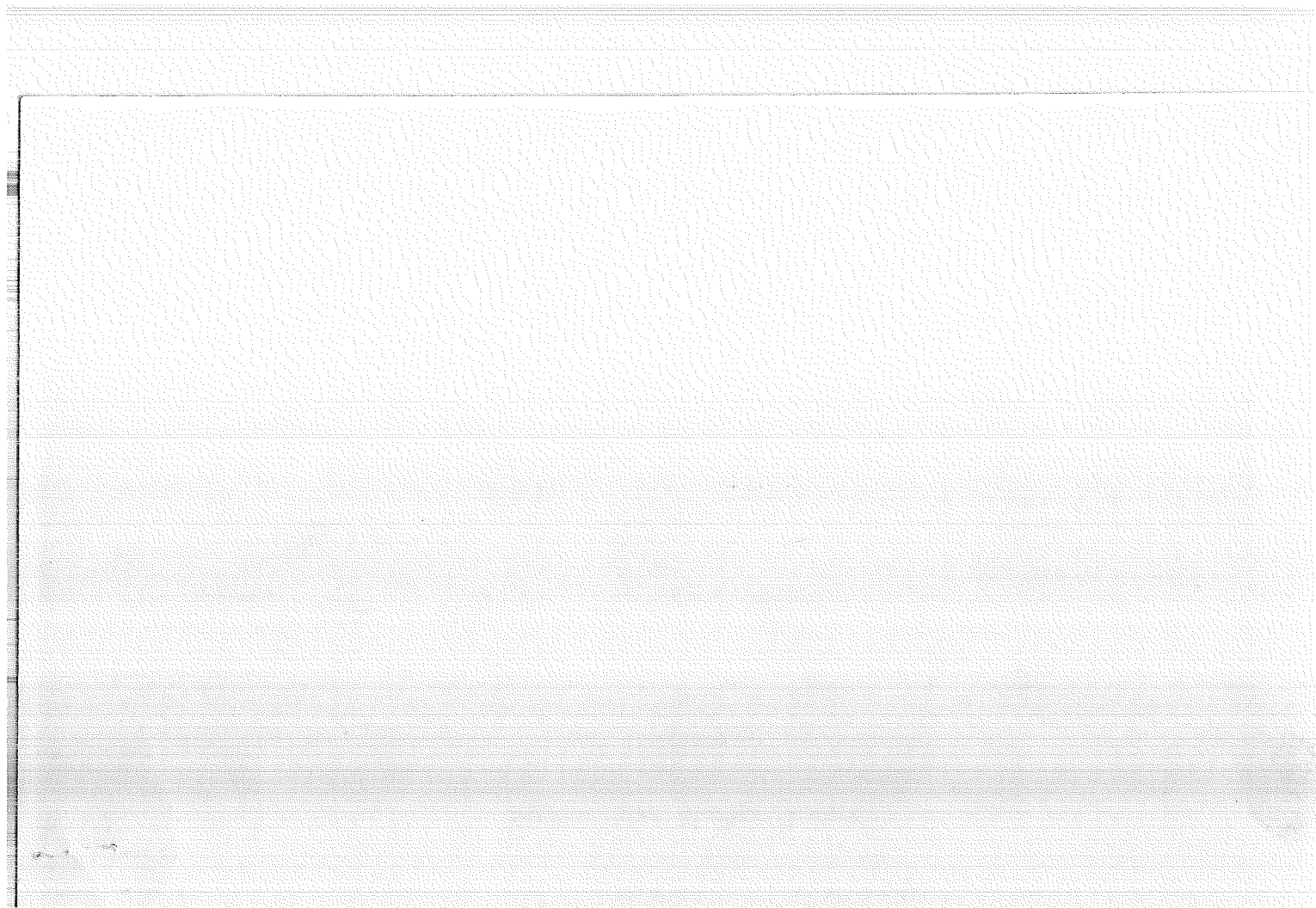

## Section Line Marker Record

#2012A East Basin Road or Trail Fort Rock District

Sec. Line between 33 &amp; 34 T. 20 S. R. 15 E.

Sec. Cor. 990 Ft. N  
¼ or Sec. feet N. S. E. or W.Posted on W side Rd  
N. S. E. or W. R. or T.Posted 7/15/52 By M. L. C.  
Date

(Approx. \_\_\_\_\_)

Cor. Found (Exact.  \_\_\_\_\_)(Paced  \_\_\_\_\_)

Distance (Chained \_\_\_\_\_)

|    |    |    |    |    |    |
|----|----|----|----|----|----|
| 6  | 5  | 4  | 3  | 2  | 1  |
| 7  | 8  | 9  | 10 | 11 | 12 |
| 18 | 17 | 16 | 15 | 14 | 13 |
| 19 | 20 | 21 | 22 | 23 | 24 |
| 30 | 29 | 28 | 27 | 26 | 25 |
| 31 | 32 | 33 | 34 | 35 | 36 |

Indicate position of marker by  
red X

If marker is on Twp. or Rge. line, reference TWP. NORTH or Rge. EAST of that line.



## Section Line Marker Record

#2012A East Basin Pine Mtn. Road or Trail Fort Rock District

Sec. Line between 27 &amp; 34 T. 20 S. R. 15 E.

Sec. \_\_\_\_\_ Cor. 1340 feet Ft. W  
¼ or Sec. \_\_\_\_\_ N. S. E. or W.Posted on E side Rd  
N. S. E. or W. R. or T.Posted 7/15/52 By M. L. C.  
Date

(Approx. \_\_\_\_\_)

Cor. Found (Exact.  \_\_\_\_\_)(Paced  \_\_\_\_\_)

Distance (Chained \_\_\_\_\_)

|    |    |    |  |    |    |
|----|----|----|--|----|----|
| 6  | 5  | 4  | 3                                      | 2  | 1  |
| 7  | 8  | 9  | 10                                     | 11 | 12 |
| 18 | 17 | 16 | 15                                     | 14 | 13 |
| 19 | 20 | 21 | 22                                     | 23 | 24 |
| 30 | 29 | 28 | 27                                     | 26 | 25 |
| 31 | 32 | 33 | <input checked="" type="checkbox"/> 34 | 35 | 36 |

Indicate position of marker by  
red X

If marker is on Twp. or Rge. line, reference TWP. NORTH or Rge. EAST of that line.

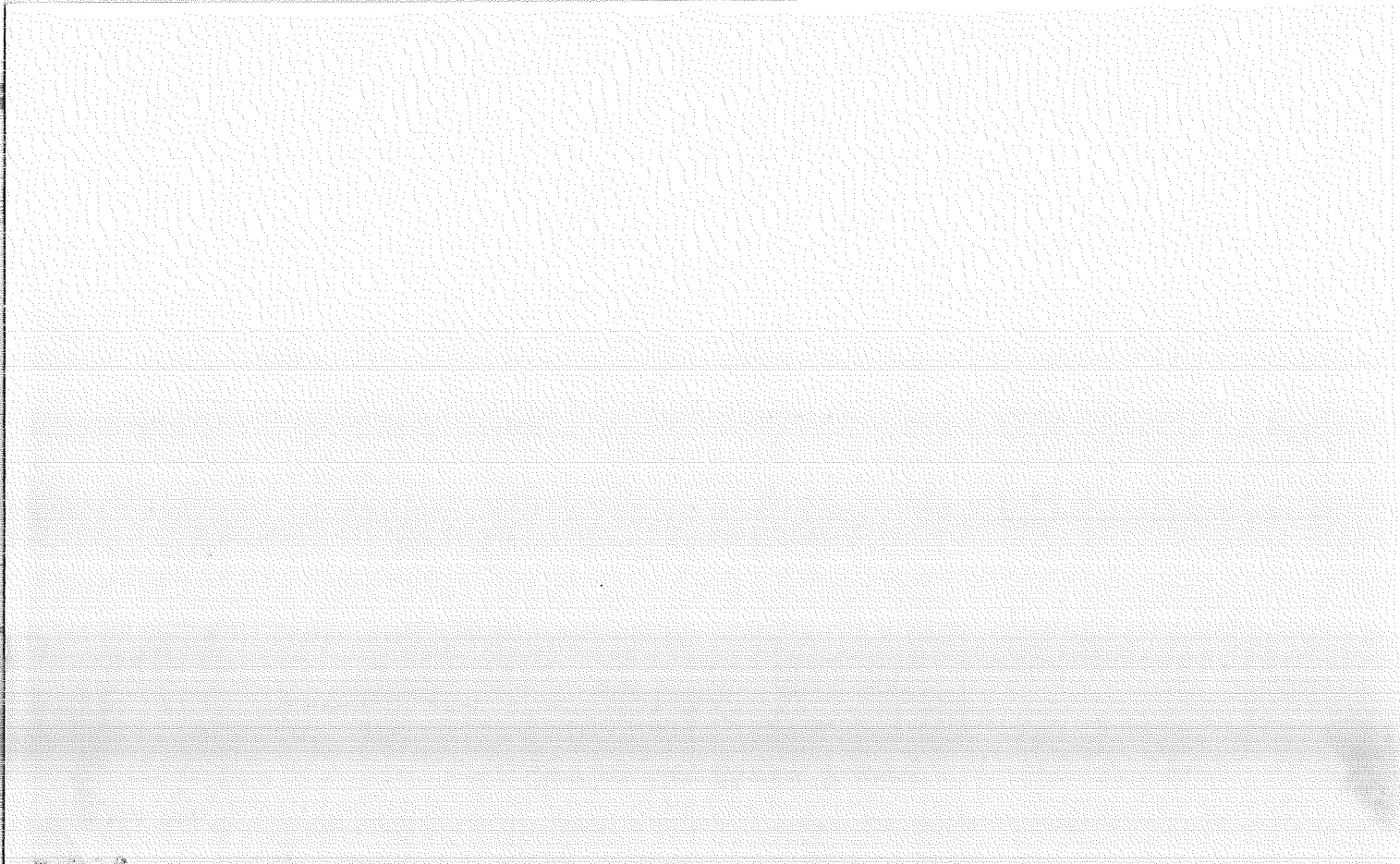

Index File No. \_\_\_\_\_

**CORNER RECORD (SEARCH)**

(Ref. FSM 7151.4)

Tract or Survey No. \_\_\_\_\_

Cor. No. V-17

T 20.5 R. 15E

R.D. Fort Rock County Deschutes

See cov

Merid. Will

N.F. Deschutes State Oregon

\_\_\_\_\_

**CORNER DIAGRAM**

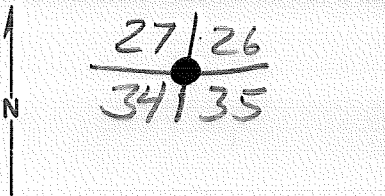

**DESCRIBE CORNER MONUMENT FOUND**

*Original Stone - 2 hacks on side; old sign grown over by Tree.*

**DESCRIBE BEARING TREES OR OTHER OFFICIAL ACCESSORIES FOUND**

**PHOTO IDENTIFICATION DATA**

Photo No. \_\_\_\_\_

Filed At. \_\_\_\_\_

Object Ident. \_\_\_\_\_

Ident. By \_\_\_\_\_

*Signature*

**PLANE COORDINATE POSITION DATA**

State \_\_\_\_\_ Zone \_\_\_\_\_

X \_\_\_\_\_

Y \_\_\_\_\_

Estab. By \_\_\_\_\_

*Agency*

**DESCRIBE CORNER LOCATION RELATIVE TO NEAR-BY FEATURES, ALSO HOW TO REACH CORNER**

*Set 5/8" Iron Pin 220'± South of cor. on Section Line.*

*See Plat*

*(Over)*

Signature DS

Title \_\_\_\_\_

Division \_\_\_\_\_

Headquarters \_\_\_\_\_

Date \_\_\_\_\_

7100-52-(3/68)

CORNER RECORD (PERPETUATION)

MONUMENT: DESCRIBE NEW MONUMENT SET, OR WORK DONE TO PRESERVE EXISTING MONUMENT

Set a 2" x 30" Gal Iron Pipe w/ Brass Cap stamped as shown.

ACCESSORIES: DESCRIBE NEW BT's WITNESS OBJECTS ETC. ESTABLISHED, OR WORK DONE TO PRESERVE EXISTING EVIDENCE

- 1. Rock 5' high 15' Cir. w/ BXO. Chized on the East face bears S 58° W w/ dist. holding 5' above monument 117<sup>0</sup> dist.
- 2. Rock 6' high 3' x 1 1/2' w/ BXO. Chized on the N.E. Face bears S 84° W 181<sup>8</sup>' dist.

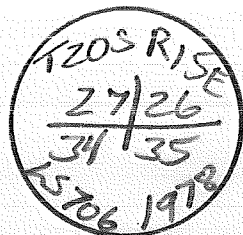

Work Done By Bruce Rogers Title Cad-Surveyor Date 4/78 State Registration No. LS 706 or Agency

Certified Cor. Record Prepared? Yes No Filed At: Date

REMARKS

Index File No.

T. 20 S R. 15 E M.

Tract or Surv. No.

Cor. V-17<sup>3</sup>



## Section Line Marker Record

#2013 Sand Springs Road or Trail Fort Rock District

Sec. Line between 31 &amp; 36 T. 20 S. R. 15 E.

1/4 Cor. 1831 Ft. S  
1/4 or Sec. feet N. S. E. or W.Posted on E side Rd  
N. S. E. or W. R. or T.Posted 7/9/52 By M. L. C.  
Date

(Approx. X

Cor. Found (Exact.

(Paced X

Distance (Chained

|    |    |    |    |    |    |
|----|----|----|----|----|----|
| 6  | 5  | 4  | 3  | 2  | 1  |
| 7  | 8  | 9  | 10 | 11 | 12 |
| 18 | 17 | 16 | 15 | 14 | 13 |
| 19 | 20 | 21 | 22 | 23 | 24 |
| 30 | 29 | 28 | 27 | 26 | 25 |
| 31 | 32 | 33 | 34 | 35 | 36 |

Indicate position of marker by  
red X

If marker is on Twp. or Rge. line, reference TWP. NORTH or Rge. EAST of that line.



### Section Line Marker Record

2012 Pine Mtn. Road or Trail Fort Rock District

Sec. Line between 33 & 34 T. 20 S. R. 15 E.

1/4 Cor. 815 Ft. N  
1/4 or Sec. feet N. S. E. or W.

Posted on N side R  
N. S. E. or W. R. or T.

Posted 7/9/52 By M. L. C.  
Date

(Approx. X)

Cor. Found (Exact. \_\_\_\_\_)

(Paced X)

Distance (Chained \_\_\_\_\_)

|    |    |    |      |    |    |
|----|----|----|------|----|----|
| 6  | 5  | 4  | 3    | 2  | 1  |
| 7  | 8  | 9  | 10   | 11 | 12 |
| 18 | 17 | 16 | 15   | 14 | 13 |
| 19 | 20 | 21 | 22   | 23 | 24 |
| 30 | 29 | 28 | 27   | 26 | 25 |
| 31 | 32 | 33 | X 34 | 35 | 36 |

Indicate position of marker by red X

If marker is on Twp. or Rge. line, reference TWP. NORTH or Rge. EAST of that line.



Index  
File No. \_\_\_\_\_

**CORNER RECORD (SEARCH)**

Tract or  
Survey No. \_\_\_\_\_

Cor.  
No. X-17

T 20S R. 15E

R.D. Fort Rock County Deschutes

E/4 CN Sec 34

Merid. Will

N.F. Deschutes State Oregon

W/4 CN Sec 35

**CORNER DIAGRAM**

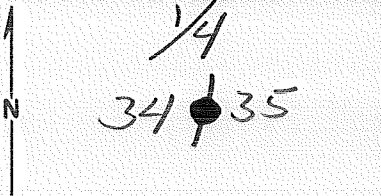

**DESCRIBE CORNER MONUMENT FOUND**

*nothing - Burnt Area.*

2

**DESCRIBE BEARING TREES OR OTHER OFFICIAL ACCESSORIES FOUND**

6

**PHOTO IDENTIFICATION DATA**

Photo No. \_\_\_\_\_

Filed At. \_\_\_\_\_

Object Ident. \_\_\_\_\_

Ident. By \_\_\_\_\_

*Signature*

7

**DESCRIBE CORNER LOCATION RELATIVE TO NEAR-BY FEATURES, ALSO HOW TO REACH CORNER**

*See Plat  
(over)*

3

**PLANE COORDINATE POSITION DATA**

State \_\_\_\_\_ Zone \_\_\_\_\_

X \_\_\_\_\_

Y \_\_\_\_\_

Estab. By \_\_\_\_\_

*Agency*

8

Signature

*DS*

Title

Division

Headquarters

Date

7100-52-(3/68)

4

5

CORNER RECORD (PERPETUATION)

MONUMENT: DESCRIBE NEW MONUMENT SET, OR WORK DONE TO PRESERVE EXISTING MONUMENT

Set a 2" x 30" Gal. Iron Pipe w/ Brass Cap Stamped as shown.

9

ACCESSORIES: DESCRIBE NEW BT'S WITNESS OBJECTS ETC. ESTABLISHED, OR WORK DONE TO PRESERVE EXISTING EVIDENCE

no R.P.'s  
Badly Burnt Area

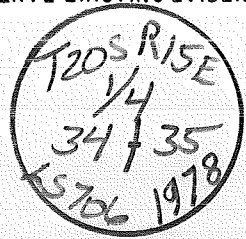

10

Work Done By Bruce Rogers Title Cad-Surveyor Date 4/78 State Registration No. or Agency LS-706

Certified Cor. Record Prepared? Yes  No  Filed At: \_\_\_\_\_ Date \_\_\_\_\_

11

REMARKS

12

Index File No.

T. 20S R. 15E M.

Tract or Surv. No.

Cor.

X-17<sup>13</sup>

### Section Line Marker Record

#2043 Sand Springs Road or Trail Fort Rock District

Sec. Line between 31 & 6 T. 20 S. R. 15 E.

Sec. \_\_\_\_\_ Cor. 1500 Ft. W  
1/4 or Sec. feet N. S. E. or W.

Posted on E side Rd  
N. S. E. or W. R. or T.

Posted 7/9/52 By M. L. C.  
Date

(Approx.           X          )

Cor. Found (Exact. \_\_\_\_\_)

(Paced           X          )

Distance (Chained \_\_\_\_\_)

|    |    |    |    |    |    |
|----|----|----|----|----|----|
| 6  | 5  | 4  | 3  | 2  | 1  |
| 7  | 8  | 9  | 10 | 11 | 12 |
| 18 | 17 | 16 | 15 | 14 | 13 |
| 19 | 20 | 21 | 22 | 23 | 24 |
| 30 | 29 | 28 | 27 | 26 | 25 |
| 31 | 32 | 33 | 34 | 35 | 36 |

X Indicate position of marker by red X

If marker is on Twp. or Rge. line, reference TWP. NORTH or Rge. EAST of that line.

THE UNIVERSITY OF CHICAGO PRESS



Index  
File No. \_\_\_\_\_

CORNER RECORD (SEARCH)

(Ref. FSM 7151.4)

Tract or  
Survey No. \_\_\_\_\_

Cor.  
No. 2-17

T 20S R. 15E

R.D. Fort Rock County Deschutes

SE Cor Sec 34 ONLY  
SW Cor Sec 35

Merid. Will

N.F. Deschutes State Ore.

CORNER DIAGRAM

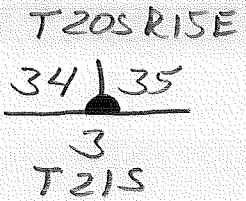

DESCRIBE CORNER MONUMENT FOUND

mound of Stone & original stone w/hacks  
old location marker in tree.

DESCRIBE BEARING TREES OR OTHER OFFICIAL ACCESSORIES FOUND

PHOTO IDENTIFICATION DATA

Photo No. \_\_\_\_\_  
Filed At. \_\_\_\_\_  
Object Ident. \_\_\_\_\_  
Ident. By \_\_\_\_\_  
*Signature*

DESCRIBE CORNER LOCATION RELATIVE TO NEAR-BY FEATURES, ALSO HOW TO REACH CORNER

See Plat  
(over)

PLANE COORDINATE POSITION DATA

State \_\_\_\_\_ Zone \_\_\_\_\_  
X \_\_\_\_\_  
Y \_\_\_\_\_  
Estab. By \_\_\_\_\_  
*Agency*

Signature DS

Title \_\_\_\_\_ Division \_\_\_\_\_ Headquarters \_\_\_\_\_ Date \_\_\_\_\_

**CORNER RECORD (PERPETUATION)**

**MONUMENT: DESCRIBE NEW MONUMENT SET, OR WORK DONE TO PRESERVE EXISTING MONUMENT**

Set a 2" x 30" Gal Iron Pipe w/ Brass Cap  
Stamped as shown.

**ACCESSORIES: DESCRIBE NEW BT'S WITNESS OBJECTS ETC. ESTABLISHED, OR WORK DONE TO PRESERVE EXISTING EVIDENCE**

A 20" P. Pine bears S87°W, 195±' Dist.

A Rock 56" x 22" x 23" protruding out of grd.

w/ BXO chiseled at base bears N7°W, 52±' Dist.

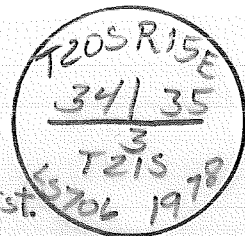

Work Done By Bruce Rogers Title Cad-Surveyor Date 4/78 State Registration No. LS 706  
or Agency

Certified Cor. Record Prepared? Yes  No  Filed At: \_\_\_\_\_ Date \_\_\_\_\_

**REMARKS**

Index File No.

T 20 S R. 15 E M.

Tract or Surv. No.

Cor. 2-17